

FINAL PROGRAM



PORTS® '22

Honolulu, Hawaii | September 18-21, 2022



Knowledge Sharing for a Better Tomorrow



Hilton Hawaiian Village | Honolulu, Hawaii
www.portsconference.org

SHIBATA**FENDER**TEAM

PLATINUM PARTNER of



▶ | on the safe side

VISIT US AT BOOTH

#114

TO FIND YOUR
INDIVIDUAL FENDER
SOLUTION

We are the leading global fender manufacturer and designer of customized fender solutions. Trust our more than **60 YEARS OF GROUP EXPERIENCE** and **130,000 FENDERS CURRENTLY IN SERVICE.**

JOIN THE SAFE SIDE – Work with ShibataFenderTeam.

CONTACT

✉ contact-americas@sft.group

☎ +1 (571) 281-3770

 www.sft.group

Contents

Schedule-at-a-Glance	3
Welcome & Committee	4
Special Events/Special Sessions	5-7
Technical Program	8-15
Exhibit Hall	17
Exhibitors	18-21
Hotel Floor Plan	22
General Information	23
Sponsors	24



Schedule-at-a-Glance *(Subject to Change)*

Sunday, September 18

6:00 – 11:30 a.m.	Registration Open, <i>Coral Lounge</i>
7:00 – 11:30 a.m.	Optimization of Port Operations Using Simulation Modeling Short Course, <i>South Pacific 4</i>
7:00 – 11:30 a.m.	Design and Construction of Large Floating Structures Short Course, <i>Sea Pearl 1/2</i>
7:00 – 11:30 a.m.	Seismic Design of Piers and Wharves Short Course, <i>Sea Pearl 3/4</i>
7:00 a.m. – 5:00 p.m.	Vessel Mooring and Berthing Short Course, <i>South Pacific 1</i>
7:00 a.m. – 5:00 p.m.	Inspection, Testing, and Rehabilitation of Waterfront Structures Short Course, <i>South Pacific 2</i>
7:00 a.m. – 5:00 p.m.	Modeling and Resilient Design Against Tsunami Hazards Short Course, <i>South Pacific 3</i>
12:30 – 5:00 p.m.	Planning, Design, and Implementation of Automated Terminals Short Course, <i>South Pacific 4</i>
12:30 – 5:00 p.m.	Theory and Design of Floating Wave Attenuators Short Course, <i>Sea Pearl 1/2</i>
12:30 – 5:00 p.m.	Dredging 201 Short Course, <i>Sea Pearl 3/4</i>
11:30 a.m. – 12:30 p.m.	Registration Closed for Lunch <i>Coral Lounge</i>
12:30 – 6:30 p.m.	Exhibitor Move-in, <i>Coral Ballroom 1-3 & Lounge</i>
12:30 – 7:00 p.m.	Registration Open, <i>Coral Lounge</i>
3:30 – 5:30 p.m.	Speaker Check-in, <i>Hibiscus</i>
5:30 – 6:30 p.m.	Student & Young Professionals Reception, <i>Nautilus</i>
6:30 – 8:00 p.m.	Exhibits Open, <i>Coral Ballroom 1-3 & Lounge</i>
6:30 – 8:00 p.m.	Ice Breaker Welcome Reception, <i>Coral Ballroom 1-3, & Lounge</i>

Monday, September 19

6:00 a.m. – 12:00 p.m.	Registration Open, <i>Coral Lounge</i>
6:30 – 8:30 a.m.	Opening Plenary, <i>Coral Ballroom 4/5</i>
6:30 a.m. – 5:00 p.m.	Exhibits Open, <i>Coral Ballroom 1-3 & Lounge</i>
8:30 – 10:00 a.m.	Concurrent Technical & Special Sessions, <i>see page 8</i>
8:30 – 10:00 a.m.	PIANC – Maritime Perspectives Across the Pacific, <i>Nautilus</i>
10:00 – 10:30 a.m.	Exhibit Hall Networking Break, <i>Coral Ballroom 1-3 & Lounge</i>
10:30 a.m. – 12:00 p.m.	Concurrent Technical & Special Sessions, <i>see page 9</i>
10:30 a.m. – 12:00 p.m.	Panel Discussion – Freedom of Navigation, <i>Nautilus</i>
12:00 – 1:00 p.m.	Registration Closed for Lunch, <i>Coral Lounge</i>
12:00 – 1:00 p.m.	Exhibit Hall Lunch, <i>Coral Ballroom 1-3 & Lounge</i>
12:00 – 2:30 p.m.	Young Professional Networking Event, <i>Coral Ballroom 4</i>
1:00 – 5:00 p.m.	Registration Open, <i>Coral Lounge</i>
1:00 – 2:30 p.m.	Concurrent Technical & Special Sessions, <i>see page 10</i>
3:00 – 4:30 p.m.	ACOPNE Induction, <i>Rainbow Suite 1/2</i>

3:00 – 5:00 p.m.	Young Professional Team Building Event, <i>Dukes Beach - Hilton Hawaiian Village</i>
4:30 – 5:30 p.m.	Speaker Check-in, <i>Hibiscus</i>
6:00 – 7:00 p.m.	Young Professional Happy Hour, <i>Maui Brewing Co - Waikiki</i>

Tuesday, September 20

6:00 a.m. – 12:00 p.m.	Registration Open, <i>Coral Lounge</i>
6:30 – 8:00 a.m.	Concurrent Technical & Special Sessions, <i>see page 11</i>
6:30 a.m. – 5:00 p.m.	Exhibits Open, <i>Coral Ballroom 1-3 & Lounge</i>
8:00 – 8:30 a.m.	Exhibit Hall Networking Break, <i>Coral Ballroom 1-3 & Lounge</i>
8:30 – 10:00 a.m.	Concurrent Technical & Special Sessions, <i>see page 12</i>
8:30 – 10:00 a.m.	MarCom Working Group 208, Planning of Automated Container Terminals, <i>Nautilus</i>
10:00 – 10:30 a.m.	Exhibit Hall Networking Break, <i>Coral Ballroom 1-3 & Lounge</i>
10:30 a.m. – 12:00 p.m.	Concurrent Technical & Special Sessions, <i>see page 12</i>
10:30 a.m. – 12:00 p.m.	ASCE 61 Special Session, <i>Sea Pearl 1/2</i>
12:00 – 1:00 p.m.	Exhibit Hall Lunch, <i>Coral Lounge & Coral Ballroom 1-3</i>
12:00 – 1:00 p.m.	Registration Closed for Lunch, <i>Coral Lounge</i>
1:00 – 2:30 p.m.	Concurrent Technical & Special Sessions, <i>see page 13</i>
1:00 – 5:00 p.m.	Registration Open, <i>Coral Lounge</i>
2:30 – 3:30 p.m.	Speaker Check-in, <i>Hibiscus</i>
6:30 – 9:30 p.m.	Gala Social Event, <i>Bishop Museum</i> , Buses depart the hotel from 5:45 to 6:00 p.m. and return between 9:30 and 10:00 p.m.

Wednesday, September 21

6:00 – 11:00 a.m.	Registration Open, <i>Coral Lounge</i>
6:30 – 8:00 a.m.	Concurrent Technical & Special Sessions, <i>see page 14</i>
6:30 – 1:00 p.m.	Exhibits Open, <i>Coral Ballroom 1-3 & Lounge</i>
8:00 – 8:30 a.m.	Exhibit Hall Networking Break, <i>Coral Ballroom 1-3 & Lounge</i>
8:30 – 10:00 a.m.	Concurrent Technical & Special Sessions, <i>see page 15</i>
10:00 – 10:30 a.m.	Exhibit Hall Networking Break, <i>Coral Ballroom 1-3 & Lounge</i>
10:30 a.m. – 12:00 p.m.	Concurrent Technical & Special Sessions, <i>see page 15</i>
10:30 a.m. – 12:00 p.m.	Sustainability and Resilience in Port Engineering Practice, <i>Nautilus</i>
1:00 – 5:00 p.m.	Exhibitor Move-out, <i>Coral Ballroom 1-3 & Lounge</i>
3:00 – 5:00 p.m.	Pearl Harbor Tour, <i>Offsite</i> , Buses depart the hotel from 2:00 to 2:15 p.m. and load between 5:00 – 5:15 p.m. to return

Thursday, September 22

6:30 – 11:30 a.m.	Ports & Harbors Committee Meeting, <i>South Pacific 1-4</i>
-------------------	---

Welcome to PORTS® '22

Welcome from the Conference Chair

Welcome to Honolulu, Hawai'i, and **PORTS '22**, the premier port engineering conference series in North America. As the sixteenth triennial PORTS conference, we strive to grow our community, honor our technical traditions and build future success by providing an exceptional learning and networking environment for all participants. Aligned with our theme, **Knowledge Sharing for a Better Tomorrow**, PORTS '22 participants will be exposed to the latest developments in the port industry and benefit from direct interaction with professionals representing the broad range of specialties serving the greater port industry. We encourage everyone to take a look at all the conference has to offer:

- An expanded and technically diverse program with nearly 200 presentations with presenters from 15 countries representing 85 organizations
- Our Sunday Short Course Series of 9 technical classes taught by industry experts designed to further your professional knowledge
- 8 panel/round-table discussions devoted to timely topics such as climate change, asset management, port infrastructure funding, and navigational freedom in the Pacific among others
- 3 ASCE design standards sessions sharing new developments and standards committee recommendations regarding the design for piers, wharves, and bulkheads
- 2 PIANC Working Group sessions presenting new design guidelines regarding planning for container terminal automation and fender design principles
- 2 Special Presentation sessions dedicated to port industry topics of local interest to Hawaiian practitioners
- Our Exhibit Hall with 70 vendors catering to our industry with ample opportunities to view the exhibits and become more aware of the breadth of services and goods available to the port industry

In addition to the traditional program, PORTS '22 also provides numerous options for participants to connect with each other to maintain industry contacts, cultivate new relationships, and increase recruiting potential. Specific social events include:

- Sunday night's Ice Breaker Welcome Reception
- Tuesday night's Gala at the Bishop Museum
- Wednesday afternoon's Navy-hosted Pearl Harbor Boat Tour

PORTS '22 also has an expanded student and younger professional program that provides specific educational and networking opportunities for the next generation of talented, energetic specialists in the port industry. Notable events developed specifically for younger professionals includes:

- Sunday night's Young Professionals Welcome Reception
- A two-part networking opportunity Monday afternoon with a Team-Building Outrigger Canoe Race and a post-race Younger Professional Social
- The PORTS 101 series is a concurrent technical track where unique, port industry experience and knowledge is shared by expert practitioners in easily digestible 20-minute presentations

The professional interaction, exchange of ideas, and cultivation of new professional contacts and opportunities remain a hallmark of the PORTS '22 Conference series. I encourage everyone to experience new ideas and grow your knowledge while basking in the beauty of Hawai'i.



William M. Bruin, P.E., D.P.E., M.ASCE
Simpson Gumpertz & Heger
PORTS® '22 Organizing Chair

PORTS® '22 Organizing Committee Chairs

Organizing Chair: William M. Bruin, P.E., D.P.E., M. ASCE, Simpson Gumpertz & Heger

Technical Program Co-Chairs: Philip Erbland, P.E., M.ASCE, S&ME, Inc.; Byan Jones, P.E., D.P.E., D.CE, M.ASCE, HDR

Short Course & PORTS 101 Chair: Danielle Goudreau, P.E., M.ASCE, Collins Engineers, Inc.

Keynote and Plenary Chair: Amanda Schindhelm, P.E., D.PE, M.ASCE, Marine Solutions, Inc.

Gala/Social Chair: Shannon Kinsella, P.E., M.ASCE, Reid Middleton

Student/YP Co-Chairs: Jon Benvenuto, LCDR, P.E., United States Coast Guard; Allison Digregorio, A.M.ASCE, Simpson Gumpertz & Heger

Sponsorship and Exhibitor Chair: Bradley Syler, P.E., S.E., M.ASCE, Marine Solutions, Inc.

Conference Staff

Tom Chase, Director, COPRI

Sean Herpolsheimer, Coordinator, COPRI

Lucy King, CMP, Senior Manager, Geo-Institute & COPRI Conferences

Sean Scully, Senior Manager, ASCE Sponsorship and Exhibit Sales

Using the PORTS® '22 App

1. Download the "ASCE Events" mobile app

Scan this QR Code or go to the Apple App Store or Google Play and search for ASCE Events.



INSTALL and OPEN the ASCE Events mobile app, then look for the PORTS '22 Conference event icon in the bottom row to open the app

CLICK the icon to launch the event app.

2. Log in to the PORTS '22 Conference app

To start using the app, click on the login button, You will be redirected to the login page to enter your ASCE Credentials to log you into the app.

Don't have an account? Use the Create Account option on the login page to set up an ASCE account.

3. Use the app and engage with the event!

Locate the schedule, add sessions to your personal schedule and search for your favorite session. Learn about our speakers, network and message other attendees (be sure to agree to "share" your information when you log in).

Our Expo Hall will be easy to navigate with the mobile app. Search for exhibitor's names, or booth listing, then use the "Find Booth" button to locate the booth on the interactive Floor Plan. You can also take notes and save them right in the exhibitor's profile listing in the app!

Sponsored by **COLLINS ENGINEERS**

Special Events/Special Sessions

Special Events

Sunday, September 18

6:30 – 8:00 p.m., Exhibit Hall, Coral Ballroom 1-3 & Lounge

Ice Breaker Welcome Reception

Included with full registration - Cash Bar

Kick off PORTS '22 with friends, colleagues, young professionals, and distinguished award winners in the Exhibit Hall. Visit and talk with our exhibitors and sponsors as we begin another successful PORTS conference. Don't miss this special opportunity to catch up with old friends and colleagues or make new contacts with similar interests.

Monday, September 19

3:00 – 4:30 p.m., Rainbow Suite 1/2

ACOPNE Induction Ceremony

Included with full registration

Get acquainted with your ACOPNE and COPRI colleagues and toast the newest Diplomates. Hawaiian Aloha business attire requested.

The Academy of Coastal, Ocean, Port & Navigation Engineers (ACOPNE) was launched in 2009 by the American Society of Civil Engineers (ASCE) to advance the practice in coastal, ocean, port, and navigation engineering by recognizing and certifying professional engineers in the profession. The ACOPNE is ASCE's third elite professional academy, comprised of nearly 250 professional engineers, who have accumulated extensive training, project experience, leadership, and high-level expertise to become eligible for Board Certification as ACOPNE Diplomates.



Tuesday, September 20

Social Gala at the Bishop Museum

6:30 – 9:30 p.m.

Included with full registration

Discover Hawai'i's history and living culture, learn about Polynesian wayfinding, and experience the thrill of an erupting volcano. Join your colleagues for an exciting evening at Honolulu's Bishop Museum. Enjoy delicious food, Hula dancers, and exclusive access to the Hawaiian Hall exhibit.



Buses will depart from the Hilton Hawaiian Village bus depot between 5:45 – 6:00 p.m. Buses will arrive at the museum between 6:30 – 6:45 p.m. Upon arrival you may visit the Hawaiian Hall exhibit in the museum or grab a drink and network with your friends and colleagues on the Great Lawn. Dinner service will follow during which Hawaiian musicians and dancers will take to the stage and entertain attendees. Buses will depart for the hotel between 9:30 – 10:00 p.m.

Wednesday, September 21

Pearl Harbor Tour

3:00 – 5:00 p.m.

Additional registration required

U.S. Navy staff will host a tour around Pearl Harbor and Ford Island. The tour is for attendees who have preregistered for the technical tour. Tour registrations are currently at capacity and any new registrants will be added to a wait list. Attendees should wear sleeved shirts, long pants, and closed-toe shoes.

Tour Schedule

- 2:00 – 2:15 p.m. Buses load and depart from the Hilton Hawaiian Village bus depot
- 3:00 – 3:15 p.m. Boat loads and departs
- 3:15 – 5:00 p.m. Tour (pre-registration required)
- 5:00 – 5:15 p.m. Buses load for return to Hilton Hawaiian Village
- 6:00 p.m. Buses return to Hilton Hawaiian Village



Special Sessions

PORTS '22 features technical tracks consisting of special discussion sessions and round tables with industry leaders.

Monday, September 19

PIANC – Maritime Perspectives Across the Pacific

8:30 – 10:00 a.m., Nautilus

Moderator: Joe D. Manous, Jr., Jr, Ph.D., P.E., D.WRE, F.EWRI, Dist.M.ASCE, Secretary United States Section of PIANC – Director US-ACE Institute for Water Resources

The session format will be six panelists providing 10 minutes of remarks and then engaging in a discussion and Q&A of current and emerging port and maritime issues within the Pacific region.

Confirmed Panelists:

- Bumgou Kang, President of the Korean Section of PIANC – President & CEO of Korea Logistics Network Corporation**
- Mitsuhiko Okada, P.E., Chair of the Japanese Section of PIANC – Managing Director, Airport Facilities Co., Ltd.**
- Helen Jenkins, Vice-President of the Canadian Section of PIANC – Senior Engineer WSP Golder**
- Nick Pansic, P.E., D.NE, M.ASCE, Vice-President of United States Section of PIANC – Vice President, Stantec Consulting Services Inc.**
- Greg Britton, Senior Board Member PIANC ANZ – Technical Director, Water & Maritime, Haskoning Australia**
- Francisco Esteban Lefler, President of PIANC**

Panel Discussion – Freedom of Navigation

10:30 a.m. – 12:00 p.m., *Nautilus*

Moderator: Brian Norris, Senior Vice President, Stantec

How the maritime engineering and construction community partners with the DOD to assure freedom of navigation globally, safeguarding commerce, health and prosperity.

Confirmed Panelists:

US Navy – RDML Jeff Kilian, NAVFAC Pacific Commander

US Army – Jose Sanchez, USACE Pacific Ocean Division

Engineering & Construction – Elizabeth Collins, President, Collins Engineers, Inc.

Shipping/Logistics – Kam Chun, Facilities Manager, Matson

Tuesday, September 20

MarCom Working Group 208, Planning of Automated Container Terminals

8:30 – 10:00 a.m., *Nautilus*

Moderators:

Tom Ward, P.E., S.E., D.P.E., M.ASCE, WSP

Ashebir Jacob, P.E., M.ASCE, Moffatt & Nichol

Join this special technical session to become familiarized with this new report presenting the state-of-the-art and best practices when planning for automation in container terminals. Digitisation and decarbonisation are disrupting the supply chain, and consequently transport infrastructure. Technological developments are, at the same time, creating attractive but non-standardised opportunities for automation. The report provides advice and guidance for port stakeholders in the planning process and the specific considerations with regards to automation. This technical session is intended to familiarize the wider engineering community with the document as a key design resource, providing a broader strategic overview of the planning and design process. This session will focus on the following four broad topics paralleling the major sections of the WG 208 report:

- The State of Automation
- The Automation Business Case
- The Terminal Planning Process
- Systems Integration

ASCE 61 Special Session

10:30 a.m. – 12:00 p.m., *Sea Pearl 1/2*

This session will include brief presentations and a panel discussion of significant changes to the next edition of ASCE 61, the Standard for Seismic Design of Piers and Wharves. Topics include revisions to the performance criteria and return periods, geotechnical provisions, structural analysis and design provisions, seismic detailing, topsides structures, and the new provisions on bulkheads.

Speakers include the following:

Gayle Johnson, P.E., M.ASCE – SGH (Committee Chair)

Joe Galloway, P.E., M.ASCE – WSP (Committee Vice-Chair)

Steve Dickenson, Ph.D., P.E., D.P.E., M.ASCE – New Albion Geotechnical

Julie Galbraith, P.E., M.ASCE – SGH

Rod Iwashita, P.E., D.P.E., F.ASCE – Port of San Francisco

Brett King, P.E., M.ASCE – WSP

Carlos Ospina, P.E., M.ASCE – SGH

Marc Percher, P.E., M.ASCE – COWI

Paul Smith – Seattle University

Jose Ugalde – Fugro

Sustainability and Resilience in Practice *Special Session Series*

Join the ASCE Sustainability Technical Committee and COPRI Ports and Harbors Committee for a series of moderated group discussions around three distinct themes of sustainability and resilience: Adaptation, Mitigation, and Management. Each 90-minute session will explore the following questions: How are port engineers and planners using sustainability and resilience in practice? What gaps exist in sustainable and resilient port engineering practices? And, what information and data is missing for creating sustainable and resilient port designs? Please attend and help influence future activities of the sponsoring committees.

Tuesday, September 20

Sustainability and Resilience in Practice – Adaptation

6:30 – 8:00 am

Moderators:

Rod K. Iwashita, P.E., D.P.E., F.ASCE, Deputy Director & Chief Harbor Engineer, Port of San Francisco

Dan Walker, Ph.D., M.ASCE, Associate Director for Multidisciplinary Studies, Center for Technology and Systems Management, University of Maryland

Sustainability and Resilience in Practice – Management

10:30 am – 12:00 p.m.

Moderator: Daniel Elroi, Asset Management Program Manager, NorthSouth GIS, LLC

Wednesday, September 21

Sustainability and Resilience in Practice – Mitigation

10:30 am – 12:00 p.m.

Moderators:

Lee Barco, P.E., D.P.E., F.ASCE, Vice-President, COPRI Governing Board; Director, Director, Global - Infrastructure Engineering, APM Terminals

Joel Farrier, P.E., MBA, M.ASCE, Chair, ASCE Sustainability Technical Committee; West US Strategic Growth Leader | Regional Environment Manager, Burns & McDonnell

Student & Young Professionals Program

PORTS '22 will feature an expanded Student and Young Professionals program including the return of our PORTS 101 track, especially focused for early-career port engineers, but equally applicable to mid-career engineers transitioning into the port industry, or senior-level managers who have port engineering oversight duties.

Sunday, September 18

Young Professionals Reception – Sunday Evening

5:30 – 6:30 p.m., *Nautilus Suite*

Cost: FREE

All young professionals are invited to this first Young Professionals event via a casual meet and greet! What better way to network amongst your peers from different parts of the world over great food and drinks!

Monday, September 19

Young Professionals Networking Event – Monday Lunch

12:00 – 1:25 p.m. | Lunch and Facilitated Networking, *Coral 4*

1:25 – 2:30 p.m. Extended Informal Networking, *Coral 4*

Cost: FREE

Are you a young professional (35 years old and under) looking to gain invaluable insight from other seasoned engineers and your peers? If you answered YES, join us at the Younger Member Networking Event! This event connects emerging, diverse young professionals with seasoned professionals that are passionate about giving back during the PORTS '22 Conference through facilitating a networking/mentorship event.

Lunch and fun are free and provided for all attendees! Be sure to download the conference app once it is available to receive updates and venue location. We look forward to seeing you there!

Young Professionals Team Building Event

3:00 – 5:00 pm, *The Beach*

Cost: \$50

Join us for an afternoon of team building and professional networking while simultaneously participating in a unique Hawaiian experience: outrigger canoeing. Participants will be randomly divided into teams of ten to race against one another in an effort to be crowned the tournament's champion. While your team is not racing, or if you aren't interested in racing, we will have music and beach activities like volleyball for you to enjoy as you watch the tournament unfold. So bring your competitive spirit, and get ready to make lasting professional connections! We look forward to meeting you!

The first 100 registrants under 35 will receive a custom PORTS '22 Hawaiian shirt, designed by the COPRI Ports & Harbors Student & Young Professionals Task Committee. *Registrants must enter their age during registration to be eligible for the giveaway.



Young Professionals Happy Hour

6:00 – 7:30 p.m., *Maui Brewing Co. - Waikiki*

Cost: FREE (limited seating)

All young professionals are invited to this casual Happy Hour! What better way to network amongst your own peers from different parts of the world over great food and drinks!

Monday, September 19–Wednesday, September 21

PORTS 101

Technical program concurrent track, *Sea Pearl 3/4*

Cost: FREE

The PORTS 101 series is a concurrent technical track where unique, port industry experience and knowledge is shared by expert practitioners in easily digestible 20-minute presentations. You can learn more about the PORTS 101 track on our interactive program.

Tuesday, September 20

Student Paper Competition

1:00 – 2:30 p.m., *Nautilus Suite*

Join the PORTS'22 Student Paper Competition finalists when they present their research during this special session. Topics include tsunamis, vessel berthing, geotechnics, and coastal processes.



Monday, September 19

6:00 a.m. – 5:00 p.m. **Registration** *(closed for lunch 12:00 – 1:00 p.m.), Coral Lounge*

6:30 a.m. – 5:00 p.m. **Exhibit Hall Open**, *Coral Ballroom 1-3 & Lounge*

6:30 – 8:30 a.m. **Opening Plenary**, *Coral IV/V*

8:30 – 10:00 a.m. **Technical Sessions**

Track A South Pacific 1	Track B South Pacific 2	Track C South Pacific 3	Track D South Pacific 4	Track E Sea Pearl 1/2	Track F Sea Pearl 3/4	Track G Nautilus
1A Environmental	1B Port Engineering	1C Port Engineering	1D Equipment & Systems	1E Terminal Planning & Design	Ports 101 – Port Structures	PIANC - Different Perspectives from Across the Pacific
<p>Moderator: Brian Enomoto, P.E., M.ASCE</p> <p>A Flood of Red Tape: Comparing the Floodplain Development Regulations of Port Cities, Peter Brennan, P.E., P.Eng., M.ASCE; Kaitlyn Frega CFM, ENV SP, WEDG, Maximo Argo, P.E., M.ASCE</p> <p>Seattle Seawall Historic, Seismic, and Operational Challenges Versus/and Habitat Improvements, N. John Bingham, P.E., M.ASCE; Emy Carpenter, P.E.; Jim Shannon; Garry Horvitz, P.E., LEG, M.ASCE</p> <p>A Probabilistic Framework for Climate Change in Design, Eric D Smith, P.E., M.ASCE, Jeffrey Oskamp, P.E., M.ASCE</p> <p>An Innovative Case Study on Industrial Coastal Resilience: Tyndall Air Force Base (TAFB), Florida, Luce Bassetti Ph.D., ENV SP, WEDG, GISP, Jason Bird CFM; Nigel Pontee, Ph.D., CEng, FICE, CWEM, CIWEM</p>	<p>Moderator: Daniel O'Connor, P.E., M.ASCE</p> <p>Developing Load Factors for Berthing Loads Based on Monte Carlo Modeling and Statistical Analysis, Rune Iversen, P.E., M.ASCE; Dolunay Oniz EIT, A.M.ASCE; Elizabeth Washburn S.M.ASCE; Brian Phan, P.E.; Allison DiGregorio M.ASCE</p> <p>Initial Investigation of Steel Pipe Pile Strain Limits for Performance-based Seismic Design, Theresa Richards, P.E., S.M.ASCE; Omar Jaradat, Ph.D., P.E., D.PE, M.ASCE; Sergio Suarez, P.E.; Jose Restrepo Ph.D.; Machel Morrison, Ph.D.</p> <p>New ASCE/COPRI Design Standards for Piers and Wharves, Omar Jaradat, Ph.D., P.E., D.PE, M.ASCE; Julian Cajiao; David Pryor, P.E.; Daryl English, P.E., M.ASCE; Cheng Lai, P.E., S.E., M.ASCE; Anthony Farmer, P.E., M.ASCE; Bill Pappas, P.E., D.PE, M.ASCE; Julie Galbraith, P.E.; Rune Iversen, P.E., M.ASCE; Raj S. Varatharaj, P.E., G.E., M.ASCE</p> <p>Proposed Framework for Seismic Assessment and Rehabilitation of Pile-supported Piers and Wharves, Carlos Ospina, Ph.D., P.E.; William Bruin, P.E., D.P.E., M.ASCE; Gayle Johnson, P.E.</p>	<p>Moderator: Bryan Jones, P.E., D.PE, M.ASCE</p> <p>Optimization of Seawall Design at Alameda Marina, Samuel Yao M.ASCE; Ali Naeem M.ASCE; Joshua Core M.ASCE; Allison DiGregorio M.ASCE</p> <p>Advancements in Galvanic Protection for Marine Structures, Rick Ellingson, P.E., NACE CP2; Jason Chodachek NACE CP2</p> <p>Offshore Technology Utilized to Accelerate Nearshore Barge Terminal Construction, Daniel E Leonard P.Eng.; Vignesh Ramadhas P.Eng.; Hong Liang P.Eng.</p> <p>Seismic Performance Requirements in the Urban Waterfront: Case Study – Repurposed 1940's Navy Wharf, Justin Reynolds, P.E., M.ASCE; Gayle Johnson, P.E.; Stephen Dickenson Ph.D., P.E., D.PE., M.ASCE; Samuel Cortes, P.E.</p>	<p>Moderator: Kevin Matakis, P.E., M.ASCE</p> <p>Balance Crane – a New Type of STS Crane in Development, Kenton Lee, P.E., S.E.; Anna Dix, P.E., S.E., M.ASCE; Simo Hoite, P.E.; Lu Yan, P.E.</p> <p>STS Crane Stowage Design: Key Considerations and Case Study, Anna Dix, P.E., S.E., M.ASCE; Erik Soderberg, P.E., S.E., D.PE, M.ASCE; Tais Shiratsubaki, P.E.</p> <p>Berthing Eccentricity Coefficient: Derivation, Application, and Use in PIANC, MOTEMS, and BS6349, Julian Cajiao; Jon Phelan P.Eng</p> <p>Design and Implementation of the World's First Fixed Track Mobile Shore Power Outlet System, Jennifer Lim, P.E.; Nathan Tang, P.E.; Edwin Draper, P.E.; Tracy Fidell, P.E.; Sean McCaskill; Matthew Trowbridge, P.E., S.E., P.Eng</p>	<p>Moderator: Thomas Spencer, P.E., S.E., D.PE, M.ASCE</p> <p>Applying Lessons Learned for a New Battery Exchange Building at the Automated Middle Harbor Terminal, Kent Saylor, P.E.; John Litzinger, P.E.</p> <p>Completing the South Texas Gateway Terminal Permitting, Design, and Construction in 18 Months, Ted Trenkwalder 2677142; Michael O'Sullivan, P.E., S.E., M.ASCE; Chris Mills, P.E.; Vince Kolbuck, P.E.; Warren Stewart, P.E., S.E. D., P.E.</p> <p>Historic Pier Restoration and Repurposing: Iconic City Pier Transformed to World Class Luxury Hotel, Jared Freeman, P.E., MCE, M.ASCE</p> <p>Design-build Delivery of Cement Imports Dock Configured for Future Liquid Exports, Viswanath Kumar P.E., S.E.; Eileen Elizondo, P.E.; Natasha Fudge, P.E.; Jyotirmoy Sircar, P.E.</p>	<p>Moderator: Danielle Goudreau, P.E., M.ASCE</p> <p>Port Structures, Danielle J. Goudreau, P.E., M.ASCE</p> <p>Waterfront Design Considerations, Justin J. Pyun, P.E., S.E., M.ASCE</p> <p>Floating Structures, Shannon Kinsella, P.E., PMP, LEED AP, M.ASCE</p> <p>Inland Ports, Stephen C. Owen, P.E., MS, M.ASCE</p>	<p>Moderator: Joe D. Manous, Jr., Ph.D., P.E., D.WRE, F.EWRI, Dist.M.ASCE</p> <p>Panelists:</p> <p>Greg Britton, Board Member, PIANC Australia and New Zealand</p> <p>Francisco Esteban Lefler, President, PIANC</p> <p>Helen Jenkins, P.Eng, Vice President, PIANC Canada</p> <p>Bumgou Kang, President, PIANC Korea</p> <p>Mitsuhiro Okada, Chair, PIANC-Japan</p> <p>Nick Pansic, P.E., D.NE, M.ASCE, Vice President for the Americas, PIANC USA</p>
10:00 – 10:30 a.m. Refreshment Break , <i>Exhibit Hall</i>						

Opening Plenary

6:30 – 8:30 a.m.,
Coral Ballroom 4/5



KEYNOTE SPEAKER

R. David Curfman, P.E., Chief Engineer and Assistant Commander for Design and Construction Naval Facilities Engineering Systems Command

In June 2019, David Curfman assumed duties as the Naval Facilities Engineering Systems Command's (NAVFAC) Chief Engineer and Assistant Commander (Director) for Design and Construction. He is the senior technical advisor and technical authority for Navy shore and ocean facilities and leads over

4000 engineering professionals delivering over \$7B per year in military design and construction services for the Navy, Marine Corps and other DoD agencies around the world. He is currently leading over \$3 billion in earthquake recovery projects at Naval Station China Lake, over \$2.5 billion in hurricane Florence recovery at MCB Camp Lejeune, numerous piers, wharves, moorings, dredging, and coastal projects, and over \$8 billion in shipyard modernization and climate adaptation projects at the four Naval Shipyards.



10:30 a.m. – 12:00 p.m. Technical Sessions						
Track A South Pacific 1	Track B South Pacific 2	Track C South Pacific 3	Track D South Pacific 4	Track E Sea Pearl 1/2	Track F Sea Pearl 3/4	Track G Nautilus
2A Environmental	2B Port Engineering	2C Port Engineering	2D Port Planning & Operations	2E Terminal Planning & Design	PORTS 101 – Inspection and Design	Panel Discussion On Freedom of Navigation
<p>Moderator: Philip Erbland, P.E., MS, M.ASCE</p> <p>Beneficial Reuse of Dredged Contaminated Sediments for Redevelopment of an Upland Cleanup Site, Jessi Massingale, P.E., M.ASCE; Corey Wilson, P.E.; Chris Hartman, P.E.</p> <p>Evaluating the Effects of Increased Dredge Depths on Existing Structures, Timothy Weeks, P.E.; Andrew Leedom, P.E.; Jeff Fisher, P.E.</p> <p>Bulkhead Barrier Wall Design and Construction Considerations: The Gowanus Canal, Kayla Newton, P.E.; Matthew Page, P.E.</p> <p>Completing the Installation of 10 Megawatts of Photovoltaic Solar Power at the Port of Los Angeles, Carlos Baldenegro, P.E., L.S.I.T., M.ASCE</p>	<p>Moderator: Anna Dix, P.E., S.E., M.ASCE</p> <p>Strengthening the Trident Wharf Prestressed Precast Planks with Advanced Composite Materials, Scott Arnold, P.E., M.ASCE; Patrick Chang, P.E.; Christina Taborga, S.E.</p> <p>Innovative Waterfront Applications of Concrete and Steel Bulkheads for Marine Terminals, Alfredo Rivera, P.E.; Carlos Ospina, Ph.D., P.E.; Ludovic Gros; Robert Rocha</p> <p>Dynamic Mooring Analysis for PortMiami North Bulkhead Cruise Berths 1-6 Realignment, Philip Hadfield, P.E., M.ASCE; Xiao (Steven) Li, P.E., Ph.D.; Desiderio Maldonado MS, P.E.; Helga Sommer, P.E.</p> <p>Restoration of Lake Erie Seawall to Accommodate Climate Change, Anilla Bayram, Ph.D., P.E., D.CE, M.ASCE; Mathew Power EIT; Sean O'Neil, Ph.D., P.E.; Alicia Kauffman; Erika Rosenstein</p>	<p>Moderator: Jeremy Burkovich, P.E., G.E., M.ASCE</p> <p>Sheet Pile Combi-Wall Reinforcement Plates, Charles Rosner P.Eng.; Scott Melvin P.Eng.</p> <p>Design Considerations for a New Marine Oil Terminal at Port of Los Angeles, Berths B238-239, Milind Desai, P.E., S.E., M. ASCE; Ernie Robledo, P.E., M. ASCE; Liang He P.E., M. ASCE</p> <p>Sheet Pile Walls Failure Case Studies; Causes and Lessons Learned, Vahid Zanjani; Majid Goodarzi Ph.D.; Mike Ajemian, P.E.</p> <p>Ras Al-Khair Dry Dock Seepage Cut-off Wall Design and Construction, Songtao Yang, P.E. Ph.D.; Reuben Grobler MSc; Chunhui liu; Honglei Wu; Umar Farooque</p>	<p>Moderator: Justin J. Pyun, P.E., S.E., M.ASCE</p> <p>Port of Los Angeles Public Access Investment Plan and Implementation for the Los Angeles Waterfront, Christine Honeybone, P.E.; Sue Lai, P.E.; Dina Aryan-Zahlan, P.E., PMP</p> <p>Ports – A Key Resiliency Hub – Before, During, and After the Storm, Paul Tschirky, Ph.D., P.Eng, DCE, MASCE; Steve Kral</p>	<p>Moderator: Jim Girouard, P.E., M.ASCE</p> <p>First Major U.S. Offshore Wind Staging Terminal: Planning, Engineering, and Construction, Elie Hasso, P.E.; Carsten Agerbæk; Joshua Singer, P.E.; Matthew Trowbridge, P.E., S.E., P.Eng</p> <p>Geotechnical and Structural Adaptations for Seismic Design of New Ferry Terminal in Washington State, Madan Karkee, Ph.D., P.E., P.Eng, M.ASCE; Andrew Gastineau, Ph.D., P.E.; Michael Chamberlain, P.E., M.ASCE; Garry Horvitz, P.E., LEG, M.ASCE; Andy Bennett, P.E.; Todd Mooney, Ph.D., P.E.</p> <p>Large Scale Dry Bulk Terminal Expansion in the Heart of Vancouver, British Columbia, Kevin Wong, P.Eng.; Jurgen Franke P.Eng., CEM; Steve Yee P.Eng., M.A.Sc.; Keith Arnstead P.Eng.</p> <p>New Ferry Terminal Provides a Resilient Solution for a Needed Commuter Route, Craig Lewis, S.E.; James Connolly, P.E., DPE; Chad Mason</p>	<p>Moderator: Jim Girouard, P.E., M.ASCE</p> <p>Geotechnical Investigation and Testing, Benjamin Serna, P.E., G.E., M.ASCE</p> <p>Underwater Inspections, Daniel Robbins, P.E. (NH)</p> <p>Pile Design, Timothy W. Smith, P.E.</p> <p>Seismic Considerations, Brian L. Phan, P.E., M.ASCE</p>	<p>Moderator: Brian Norris</p> <p>Panelists: Jeffrey J. Kilian, Commander, Naval Facilities Engineering Command Pacific/ Director Jose E. Sanchez, P.E., Director of Regional Business, U.S. Army Corps of Engineers Elizabeth M. Collins, P.E., D.PE, F.ASCE, Executive Vice President Collins Engineers, Inc. Kam Chun, Facilities Manager, Matson</p>
12:00 – 1:00 p.m. Exhibit Hall Lunch						

Thank You to Our Sponsors!

Conference Registration Bag, Sponsored by Whitman, Requardt and Associates
 Mobile Application, Sponsored by Collins Engineers
 Conference Lanyards, Sponsored by WSP
 Conference Hotel Key Cards, Sponsored by KPFF
 Interactive Itinerary Planner, Sponsored by Marine Solutions
 In-Room Nightly Amenity, Sponsored by Schrader Co.

Laser Pen, Sponsored by Appledore Marine Engineering Program, Sponsored by Shibata Fender Team and Stantec
 Pre-Conference Short Courses, Sponsored by Moffat & Nichol
 Pearl Harbor Tour, Sponsored by GeoEngineers, GHD, Moffat & Nichol, Reid Middleton, and WSP
 YP Program, Healy Tibbits



Technical Program *(continued)*

1:00 – 2:30 p.m. Technical Sessions						
Track A South Pacific 1	Track B South Pacific 2	Track C South Pacific 3	Track D South Pacific 4	Track E Sea Pearl 1/2	Track F Sea Pearl 3/4	Track G Nautilus
3A Environmental	3B Port Engineering	3C Port Engineering	3D Landside Connections	3E Terminal Planning & Design		
<p>Moderator: Ali Naeem, P.E., M.ASCE</p> <p>Coupled Modeling Approach to Quantify Shoreline Erosion and Beach Morphology Due to Passing Vessels, Scott Fenical, P.E., D.CE, D.PE; Francis Salcedo, P.E., M.ASCE; Abhishek Sharma Ph.D.</p> <p>Designing Ports for Rising Seas: PortMiami's Approach to Staying Afloat, Erica Harris ENV SP, WEDG; Justin Vandever, P.E.; Philip Hadfield, P.E., M.ASCE; Helga Sommer, P.E.</p> <p>Development of New PIANC Guidance for the Beneficial Use of Dredged Material, Burton Suedel; Victor Magar; Luca Sittori</p> <p>Fast-track Integrated Environmental Cleanup & Maritime Terminal Redevelopment of Former Mill Site, Nathan Watson, P.E., M.ASCE; Dylan Frazer LG; Jeff Becker, P.E.; Erik Gerking</p>	<p>Moderator: Gayle Johnson, P.E., M.ASCE</p> <p>2D and 3D Physical Model Testing of Mega Port Projects, Bill Paporis, P.E., D.PE, M.ASCE; Atila Bayram, Ph.D., P.E., D.CE, M.ASCE; Sean O'Neil, Ph.D., P.E.; Noa Oren; Daniela Ostrovsky; Avi Elgaba</p> <p>Innovative Dock Mooring Solution for a Historically Sensitive Area, Craig Lewis, S.E.; Camille Gouzum EIT; Robert Sherwood, P.E.; Paul DePrey; Andrew Rocheleau</p> <p>Physical Modeling of Hard Structure Effects on Tsunami Force Reduction in Urban Coastal Environment, Sungwon Shin, Ph.D., A.M.ASCE; Hyoongsu Park Ph.D.; Hai Van Dang; Dayeon Lee; Daniel Cox Ph.D.</p> <p>Recommendations for Durable Anchor Pile Design in Floating Structures, Christine Smith, P.E.; Dennis O'Heney EIT</p>	<p>Moderator: Julie Galbraith, P.E., M.ASCE</p> <p>Case History of a Rehabilitated Port Facility After the 2016 Ecuador Earthquake, Pedro Rojas, Ph.D., Ing., M.ASCE; José Barros M.Sc.; Dióselina Rosero ENG.; Leandro García, ENG.; Eduardo Miranda Ph.D.; Wilmer Márquez, ENG.</p> <p>Design Challenges – Seward Marine Center, Arctic Research Vessel Berth in Seward, Alaska, M.R. Hasan, P.E., PMP, M.ASCE; Jim Van Ness, P.E., M.ASCE</p> <p>Overcoming Operative, Construction & Design Challenges Widening the Dock Entrance at Boston Port, UK, Mary Schafner CEng MICE; Sergio Solera C.Eng, FICE; Peter Mallin MIE Aust; Myles Bethell C.Eng, MICE; Stephan Van Eeden C.Eng, MICE; Charlie Bell C.Eng, MICE; Lorenzo Allievi C.Eng, M.ASCE, MICE</p> <p>Designing for Inland Waterway Operational Continuity Throughout High and Low Water Levels, Danielle Goudreau, P.E., M.ASCE; Ryan McCoy, P.E.; Elizabeth M. Collins, P.E., D.PE, F.ASCE</p>	<p>Moderator: Shane Phillips, P.E., D.CE, D.PE, M.ASCE</p> <p>Bigger Isn't Better – Managing Uncertainty to Phase the Pier B On-dock Rail Support Facility, Nathan deSousa, P.E., M.ASCE; Ron Richardson, P.E., CA; Try Khou, P.E.</p> <p>Ground Improvements for Georgia Ports Mason Mega Rail Project, Guoming Lin, Ph.D., P.E., D.GE, F.ASCE; Christopher Novack, P.E.; Oliver Himbert, P.E.; Brad Woodall, P.E.; Daniel Peavy; Honor Hutton, P.E.</p> <p>Rail System Strategic Planning and Lessons Learned Through Major Events, Michael Leue, P.E.; Kerry Cartwright, P.E.; Shashank Patil MS; Carlo Luzzi</p> <p>The Mega Rail Project: Increasing Intermodal Capacity, While Maintaining Intermodal Operations, Daniel Peavy</p>	<p>Moderator: Alex Mora, P.E., D.PE, M.ASCE</p> <p>New Graving Dock Design Considerations and Challenges, Ajaya Malla MS, P.E., M.ASCE</p> <p>Planning and Simulation of Large-scale Container Terminal Consolidation for Smart Port Initiatives, Alan Zhang</p> <p>San Francisco Floating Fire Station 35: Overview and Lessons Learned, Erik Soderberg, P.E., S.E., D.PE, M.ASCE; Leah Olson, P.E.; Di Liu, P.E.</p> <p>Tsunami Design Approaches for Resilient Ferry Terminals, Chris Stearns, P.E., S.E., M.ASCE</p>		
3:00 – 4:30 p.m. ACOPNE Induction, Rainbow Suite 1/2						
3:00 – 5:00 p.m. YP Team Building, Dukes Beach						
4:30 – 5:30 p.m. Speaker Check-in, Hibiscus 1/2						
6:00 – 7:00 p.m. YP Happy Hour, Maui Brewing Co. – Waikiki						



PIANC USA

Visit us at booth #134
to learn how you
can get involved.



Tuesday, September 20

6:00 a.m. – 5:00 p.m. Registration (closed for lunch 12:00 – 1:00 p.m.), <i>Coral Lounge</i>						
6:30 a.m. – 5:00 p.m. Exhibit Hall Open , <i>Coral Ballroom 1-3 & Lounge</i>						
6:30 – 8:00 a.m. Technical Sessions						
Track A South Pacific 1	Track B South Pacific 2	Track C South Pacific 3	Track D South Pacific 4	Track E Sea Pearl 1/2	Track E Sea Pearl 1/2	Track E Sea Pearl 1/2
4A Environmental	4B Port Engineering	4C Port Engineering	4D Navigation & Waterways	4E Hugh K. Leatherman Terminal	Ports 101 - Sustainability and Resiliency	Sustainability & Resilience Discussion – Adaptation
<p>Moderator: Scott Fenical, P.E., D.CE, D.PE</p> <p>Innovative Approaches for Port-led Advance Mitigation and Mitigation Banking, Dan Berlin PWS</p> <p>Holistic Design of Resilient and Adaptive Waterfronts and Application in San Francisco, Luce Bassetti Ph.D., ENV SP, WEDG, GISP; Darren Nilsom CEng, MICE; Brad Benson</p> <p>Innovative Collection & Reporting for Marine Mammal Monitoring, Portsmouth Naval Shipyard Dry Dock 1, Alexander Pries, MS; Douglas Stewart; Ian Trefry; Kari Moore</p> <p>Stabilization of Dredged Sediments: Enabling Beneficial Re-use Solutions in a Contaminated Port, Tom Gillespie CPEng</p>	<p>Moderator: Scott Kuebler, P.E., S.E., M.ASCE</p> <p>Case Study – Lateral Pile Testing for Seismic Design in Unexpected Soil Conditions, Benjamin Pesicka, P.E., S.E.; Lyle Stone, P.E., GE, M.ASCE; Timothy O'Neill</p> <p>Joint Probability Extremal Analysis of Combined Storm Surge and Precipitation, Craig Harter, P.E., A.M.ASCE; Patrick McLaughlin, P.E., M.ASCE; Darren Price; Josh Carter, P.E., D.CE, M.ASCE; Luis Maristany, P.E.</p> <p>Palmer Station Antarctica Pier Replacement -Logistics and Design for Remote Construction, TJ Schilling; John Daley, P.E., S.E.</p> <p>Toe Wall Design and Construction for Busy Container Berth Deepening, Jyotirmoy Sircar, P.E.; Alfredo Rivera, P.E.; Leon Carrillo</p>	<p>Moderator: Cheryl Coviello, P.E., D.PE, M.ASCE</p> <p>Berths 226-236 Terminal Redevelopment Construction Lessons Learned at the Port of Los Angeles, Brian Correa Aff.M.ASCE; Rosario Lauro EIT; Marco Sanchez, P.E., M.ASCE; Omar Jaradat, Ph.D., P.E., D.PE, M.ASCE; Arul Arulmoli, Ph.D., P.E., G.E., FASCE</p> <p>Fender System Construction Using Cluster Drilling: Case Study of the New Goethals Bridge, Mina Mikaeel, P.E.; Ioannis Sokratis Drakatos Ph.D.; John Waldorf; Suheil Lahdo-Abdi; Abdolrasool Attar</p> <p>Hawaii's New Container Terminal for the 21st Century Honolulu Harbor, Oahu, Hawaii, Dean Kokubun</p> <p>Water Injection Dredging, a Cost-effective Force of Nature, Robert Wagner, P.E., DNE, BCEE, MASCE</p>	<p>Moderator: Jonathan Armbruster, P.E., MS, M.ASCE</p> <p>Modeling Structural Alternatives to Reduce Navigation Channel Shoaling in Waukegan Harbor, Illinois, Lihwa Lin; Zeki Demirebilek</p> <p>Real-time Vessel Navigation Simulations in Design of Naval Station Channel Reconfiguration, Gwen Lawrence</p> <p>SMART Planning and Deep Draft Navigation: Houston Ship Channel Expansion Channel Improvement Project, Ashley Judith, P.E., MS, M.ASCE; Lori Brownell, P.E., D.NE, M.ASCE; Dana Cheney; Richard Ruchhoeft, P.E., M.ASCE</p> <p>When a Breakwater Does Not Look Like a Breakwater by Emulating Nature, Jack Cox, P.E., D.CE, D.NE, D.PE, M.ASCE</p>	<p>Moderator: Edward Stehmeyer, P.E., M.ASCE</p> <p>Hugh K. Leatherman Terminal – Transforming a Former Naval Facility into a Modern Container Terminal, Edward Stehmeyer, P.E., M.ASCE; Edward (Butch) Weber, P.E., M. ASCE; Mark Messersmith CEM</p> <p>Hugh K. Leatherman Terminal – Site Preparation, Surcharge Program, Utilities and Foundation Design, Edward (Butch) Weber, P.E., M. ASCE; Lucy Terza, P.E., M. ASCE; Ryan Keiper, P.E., SM, M. ASCE</p> <p>Hugh K. Leatherman Terminal – A Mega Project Success Nearly 20 Years in the Making, Edward (Butch) Weber, P.E., M. ASCE; Lucy Terza, P.E., M. ASCE; Andrew Thiess, P.E., PMP; Edward Stehmeyer, P.E., M.ASCE</p> <p>Hugh K. Leatherman Terminal – Wharf Extension Design Considering Phase 1 Lessons Learned, Craig McGillawee, P.E., M.ASCE; Ryan Keiper, P.E., SM, M. ASCE; Lucy Terza, P.E., M. ASCE</p>	<p>Moderator: Andrew Cairns, P.E., D.P.E., PMP, M.ASCE</p> <p>Coastal Modeling 101, Matthew Shultz, P.E., D.CE, M.ASCE</p> <p>Offshore Wind Readiness, Joshua Singer, P.E.</p> <p>Offshore Wind Development: A Geodata Approach, Jack Koban, Ph.D., P.E., P.G., M.ASCE</p> <p>Structural Impacts to Seawalls from Ocean Hazards, Oceana Francis, Ph.D., P.E., M.ASCE</p>	<p>Moderators: Rod K. Iwashita, P.E., D.PE, FASCE; Dan Walker, Ph.D., M.ASCE</p>
8:00 – 8:30 a.m. Exhibit Hall Networking Break , <i>Coral Ballroom 1-3 & Lounge</i>						



Technical Program *(continued)*

Tuesday, September 20 *(continued)*

8:30 – 10:00 a.m. Technical Sessions						
Track A South Pacific 1	Track B South Pacific 2	Track C South Pacific 3	Track D South Pacific 4	Track E Sea Pearl 1/2	Track F Sea Pearl 3/4	Track G Nautilus
<p>5A Environmental</p> <p>Moderator: Robert Snover, P.E., D.OE, D.PE, M.ASCE</p> <p>Machine Learning Based Seagrass Growth Prediction for Mitigation and Habitat Assessment, Patrick McLaughlin, P.E., M.ASCE; Josh Carter, P.E., D.CE, M.ASCE; Abhishek Sharma Ph.D.; Arpit Agarwal, P.E., M.ASCE; Scott Fenical, P.E., D.CE, D.PE</p> <p>Maryland Port Administration, Dundalk Marine Terminal, Resiliency for an Active RO/RO Terminal, John Schirmer, P.E.; Steven Johnson, P.E.</p> <p>Military Installation Coastal Resiliency Planning and Adaptation Alternative Communications, Alex Viana PMP; John Ouellette</p> <p>Keeping the Vision: A Small Port's Journey to Comprehensive Remediation of a Wood Treating Site, Joshua Elliott, P.E.; Laurie Olin</p>	<p>5B Port Engineering</p> <p>Moderator: Scott Schlechter, P.E., G.E., M. ASCE</p> <p>Design of Concrete Deep Draft Captured Camels, Catrina Walter, P.E., M.ASCE; Clinton Brantlund, P.E., S.E., LM.ASCE; Tyson Boling, P.E.; David Gibson, P.E.</p> <p>Pier Design Using Coupled Orthogonal Lateral Systems for Liquefaction and Seismic Loading, Justin Rygel, P.E., S.E., MS; Benjamin Pasicka, P.E., S.E.</p> <p>Probabilistic Approach to Compute Extreme Value Loading on Marine Structures, Arpit Agarwal, P.E., M.ASCE; Tessa Syvertsen M.ASCE; Patrick McLaughlin, P.E., M.ASCE; Josh Carter, P.E., D.CE, M.ASCE</p>	<p>5C Port Engineering</p> <p>Moderator: Matthew Martinez, P.E., S.E., D.PE, M.ASCE</p> <p>Geospatial Technologies in Action at the Port of Long Beach, Miguel Hernandez, P.E., M.ASCE</p> <p>Cellular Cofferdam Pier Rehabilitation Design, Timothy Smith, P.E.; Matthew Page, P.E.</p> <p>Multi-scale Numerical Simulation of Tsunami-driven Debris-field Impacts, Justin Bonus MS; Pedro Arduino Ph.D.; Marc Eberhard Ph.D.; Michael Motley, Ph.D., P.E.</p> <p>PED Crane and Infrastructure Upgrade Project: Overview and Lessons Learned, Erik Soderberg, P.E., S.E., D.PE, M.ASCE; Sugiarto Loni; Claude Gentil, P.E.; Arun Bhimani, P.E., S.E.</p>	<p>5D Port Planning & Operations</p> <p>Moderator: Noah Elwood, P.E., D.OE, D.PE, M.ASCE</p> <p>21st Century Opportunities, Hazards, Roles, and Responsibilities Facing the Nation's Water Resources, Joe Manous, Ph.D., P.E., D.WRE, FEWR, Dist.M.ASCE; Elizabeth M. Collins, P.E., D.PE, FASCE</p> <p>Coastal Practice for Flood Resiliency Projects, Xiao (Steven) Li, P.E., Ph.D.; Abbas Sarmad, P.E.</p> <p>How U.S. West Coast & Hawaii Ports Can Prepare for the Unique Requirements of Floating Offshore Wind, Carly Willmott, P.E., M.ASCE</p> <p>Traffic Management While Building New Gerald Desmond Bridge and Middle Harbor Container Terminal, Rajeev Seetharam, P.E., T.E., CPE; Peter Kim, P.E., T.E.; Theresa Dau-Ngo AICP</p>	<p>5E Seismic Design of Bulkheads</p> <p>Moderator: Pooja Jain, P.E., P.Eng, S.E., M.ASCE</p>	<p>PORTS 101 – Vessel Loading and Considerations</p> <p>Moderator: Carlos Peña, P.E., M.ASCE</p> <p>Vessel Particulars, Maximo Argo, P.E., M.ASCE</p> <p>Dredging 101, Scott J. Stainer, P.E.</p> <p>Berthing & Mooring in Demanding Environments 1, Nick Labrosse; Mick Langford</p> <p>Berthing & Mooring in Demanding Environments 2, Nick Labrosse; Mick Langford</p>	<p>5G PIANC Working Group 208: Planning of Automated Container Terminals</p> <p>Moderator: Thomas Ward, P.E., S.E., D.PE, M.ASCE</p> <p>Panelist(s)</p> <p>Ashebir Jacob, P.E., M.ASCE, Vice President Moffatt & Nichol</p> <p>Thomas Ward, P.E., S.E., D.PE, M.ASCE, Maritime Planning Guru WSP USA</p> <p>Dimitrios Pachakis, Ph.D., P.E., MICE, Technical Director, Maritime, Moffatt & Nichol</p> <p>Sylvia Wong, M.PIANC, Principal, Smart Ports / Terminals, Hatch</p>
10:00 – 10:30 a.m. Exhibit Hall Networking Break, Coral Ballroom 1-3 & Lounge						
10:30 a.m. – 12:00 p.m. Technical Sessions						
Track A South Pacific 1	Track B South Pacific 2	Track C South Pacific 3	Track D South Pacific 4	Track E Sea Pearl 1/2	Track F Sea Pearl 3/4	Track G Nautilus
<p>6A Environmental</p> <p>Moderator: Donald Oates, P.E., P.Eng., D.P.E., DBIA, M.ASCE</p> <p>PIANC WG 175-Practical Guide to Environmental Risk Management for Navigation Infrastructure Projects, John Lally, P.E., M.ASCE; Miran Vanwonderghem; Amy Parry; Todd Bridges Ph.D.; Rebecca Gardner, P.E.; Burton Suedel; Kevin Kane Ph.D.; Kevin Allen</p> <p>Port Houston: The Business Case for Emissions Reduction Strategies, Vijaykumar Agrawal, P.E., M.ASCE; Adithya Dahagama</p> <p>Port of Los Angeles Resiliency in Capital Improvement Projects, Adrienne Newbold, P.E., M.ASCE</p>	<p>6B Port Engineering</p> <p>Moderator: Michael Wray, P.E., M.ASCE, LEED AP</p> <p>Equino South Riding Point Sea-island Berth 2 Repairs, Grand Bahamas, Charles Rosner P.Eng.; Marcel Deveau P.Eng.; Jay Vadodaria M.Sc.; Mike Martell P.Eng.</p> <p>Innovative Deepening of Maher Container Terminal Berths 64/66, Christopher Lawrence; Songtao Yang, P.E. Ph.D.; Arundhati Bhosle, P.E.; Louis Allora C.P.E</p> <p>Toe Wall Analysis, Design, Installation and Trouble Shooting at the Port of Hueneme, Adam Bergman, P.E., M.ASCE; Sean Story, P.E.; Christina Birdsey 4883677; Todd Graham, D.PE, M.ASCE</p> <p>Towards Performance-based Seismic Design of Shiploaders, Maged Ghali M.Eng., P.Eng.; Sherief Sakla M.ASCE, Ph.D., P.E., P.Eng.</p>	<p>6C Port Engineering</p> <p>Moderator: Sean Chapman, P.E., A.M.ASCE</p> <p>A Sea Level Rise Resilient Design for the Royal Hawaiian Groin, Scott Sullivan, MS; David Smith Ph.D., P.E., M.ASCE</p> <p>Development of Major Ferry Homeport in Dense Urban Waterfront, David Jones, P.E.; Simon Betsalel; Stephen Famularo, P.E., D.PE</p> <p>From 2D to 3D: modeling to Refine Design of a New King-pile Bulkhead, Cheryl Coviello, P.E., D.PE, M.ASCE; Yixing Yuan, P.E.; Dino Fiscoletti, P.E.</p> <p>Humboldt Bay Offshore Wind Port Assessment, Aaron Porter, P.E., M.ASCE; Shane Phillips; Michelle Gostic MS</p>	<p>6D Port Infrastructure</p> <p>Moderator: Anne Porter, P.E., MBA, LEED AP, CSBA, M.ASCE</p> <p>Bulkhead Wall Reconstruction Under Active Transit Shed with Ongoing Cargo Operations, Nick Pestello, P.E.; Matthew Trowbridge, P.E., S.E., P.Eng; Elie Hasso, P.E.; Michael Hasen, P.E.; Adrian Pearson</p> <p>Corrosion Mitigation and Prevention of Port Infrastructure, Brian Pailles, Ph.D., P.E., NACE CPS</p> <p>Experiences Gained from Construction of Middle Harbor Automated Terminal at the Port of Long Beach, Cesar Larios, P.E., CCM</p> <p>Keeping Old Running as New at Portsmouth Naval Shipyard, Lukian Harris, P.E.; Danielle Somma, P.E.; Tor Harris, P.E.; Kirk Riden, P.E.</p>	<p>6E ASCE 61</p> <p>Moderator: Gayle Johnson, P.E., M.ASCE</p> <p>Joe Galloway, P.E., M.ASCE</p> <p>Steve Dickenson, Ph.D., P.E., D.PE, M.ASCE</p> <p>Julie Galbraith, P.E., M.ASCE</p> <p>Rod Iwashita, P.E., D.PE, F.ASCE</p> <p>Brett King, P.E., M.ASCE</p> <p>Carlos Ospina, P.E., M.ASCE</p> <p>Marc Percher, P.E., M.ASCE</p> <p>Paul Smith</p> <p>Jose Ugalde, Fugro</p>	<p>PORTS 101 – Technology, Planning, and Management</p> <p>Moderator: Barritt Lovelace, P.E.</p> <p>Digital Twins for Dummies, Bibhuti Aryal</p> <p>Green Port Policy Now & Tomorrow, John Chun, P.E.</p> <p>Project Management and Financials, Charlie William Marshall Roberts, P.E., D.PE, M.ASCE</p> <p>Cost Estimating, Ryan M. McCoy, P.E.</p>	<p>Sustainability & Resilience Discussion – Management</p> <p>Moderator: Daniel Elroi</p>
12:00 – 1:00 p.m. Exhibit Hall Lunch, Coral Ballroom 1-3 & Lounge						

1:00 – 2:30 p.m. Technical Sessions						
Track A South Pacific 1	Track B South Pacific 2	Track C South Pacific 3	Track D South Pacific 4	Track E Sea Pearl 1/2	Track F Sea Pearl 3/4	Track G Nautilus
7A Environmental	7B Port Engineering	7C Port Engineering	7D Port Infrastructure	New ASCE/COPRI Design Standards for Piers and Wharves Committee Interaction and Owners Perspective		7G Student Paper Competition
<p>Moderator: Paul Roberts, P.E., M.ASCE</p> <p>MDOT MPA's Innovative Reuse and Beneficial Use of Dredged Material Program, Walter Dinicola, P.E.</p> <p>Salmon Habitat Restoration Design and Permitting at Vigor Shipyards, Seattle, Erin Murray; Johnathan Cook, P.E.; Scott Stainer, P.E.; Kate Snider, P.E.</p> <p>Conley Terminal Soil Reclamation and Reuse Program: A Story of Successful Contaminated Material Management, Ileen Gladstone, P.E., LSP; Nhuy Hoang; Chester Myers</p>	<p>Moderator: Azadeh Bozorgzadeh, Ph.D., P.E., M.ASCE</p> <p>Building a Resilient and Sustainable Waterfront at the US Naval Academy, Stephen Owen, P.E., MS, M.ASCE; William Young, P.E., S.E., M.ASCE; John Jones, P.E.</p> <p>Wharf Upgrades for an Active Cruise Terminal to Accommodate Larger Vessels, Desiderio Maldonado MS, P.E.; Scott Fenical, P.E., D.CE, D.PE; David Conrad, P.E., M. ASCE; Ashwin Parambath, P.E., M. ASCE; Abhishek Sharma Ph.D.</p> <p>USCG Sector Buffalo Boat Basin Wave Study: Optimization of Wave Attenuators Using Numerical Modeling, Jon Benvenuto, P.E., PMP; Sharon Chader, P.E.; Cedric Wrobel EIT; Greg DeVan, P.E.</p> <p>Wind Loads on Ships at Berth with Computational Fluid Dynamics (CFD), Claudio Fassardi; James Fletcher; Sandeep Upadhy</p>	<p>Moderator: Mustafa Samad Ph.D., P.Eng, M.ASCE</p> <p>Dolomite Drivability and Combination Wall Systems for Terminal Rehabilitation, Eric Fleet, P.E., LEED Green Associate; William Bruin, P.E., D.P.E., M.ASCE; Rose McClure, S.E., P.E., LEED AP BD+C</p> <p>New Shiploader Foundations Within Existing Post-tensioned Wharf in Region of High Seismicity, Christopher Meisl MASC, P.Eng.; Andre Drotwa PEng, MEng; Eric Liu MASC, LEED Green Associate, PEng; Andrew Quinn PEng.</p> <p>Port of Los Angeles Berth 83 Town Square Project – Design, Construction, and Impact of the Pandemic, John Posadas, P.E., M.ASCE; Briella Matsumoto, P.E.</p> <p>What Is a Safe Safe Working Load for Your Bollard? Erik Broos MSc.; Jan Dlugosch; Jörg Pollmann; Wim Hoebee MSc.; Nils Tammen; Adrian Kahl Dipl. Ing.</p>	<p>Moderator: Elizabeth M. Collins, P.E., D.PE, F.ASCE</p> <p>Structural Rehabilitation to an Active Container Facility: A Collaborative Approach, Alan Pepin, P.E., M.ASCE; Nhuy Hoang; Chester Myers</p> <p>The Entrance Structure, Matthew Teeden, P.E., S.E., D.OE, D.PE, M.ASCE; Eric Levesque, P.E.; David Marcotte, P.E.; Diana McCullough, P.E.; Linn Lebel, P.E.</p> <p>Waterfront Inspections Using Light and Sound, John Loftus, P.E., M.ASCE; Mike Russalesi; Russel Batman</p> <p>Remote and Robust – Reinforcing a Marine Berth to Withstand the Bering Sea at Eareckson Air Station, Lukian Harris, P.E.; Noah Elwood, P.E., M.ASCE</p>	<p>Moderator: Omar Jaradat, Ph.D., P.E., D.PE, M.ASCE</p> <p>Panelists:</p> <p>Rune Iversen, P.E., M.ASCE Bill Papis, P.E., D.PE, M.ASCE Anthony Farmer, P.E., M.ASCE Rod Iwashita, P.E., D.PE, F.ASCE Angel Lim, P.E., S.E., M.ASCE Joseph Ackroyd, P.E. Daryl English, P.E., M.ASCE Joel Aguilar, P.E., S.E., M. ASCE Julian Cajiao</p>		<p>Moderator: Jon Benvenuto, P.E., PMP</p> <p>Probabilistic Fragility Analysis of Reinforced Concrete Structures under Tsunami Hydrodynamic Loads of the ASCE 7 Standard, Mostafa Hassan Fathi Abdelhafeez</p> <p>A Simulation Study on Risk Associated with Berthing Loads for Load Factor Development, Elizabeth A. Washburn, A.M.ASCE, EIT</p> <p>Evaluation of a Proposed Magnetic Jar Separation Test to Determine Glauconite Content, Christopher J. Sylvia, S.M.ASCE</p> <p>4D Nearshore Wavefield by a Low Cost Stereo Video System, Matheus Vieira, MS</p>
2:30 – 3:30 p.m. Speaker Check-in, Hibiscus						
6:30 – 9:30 p.m. Gala, Bishop Museum						

Board Certification in Port Engineering

The highest level of advanced postlicensure certification for professional engineers.

Much more than a distinguished achievement, board certification helps ensure that competent engineers in this specialty are identified to the public and project owners/sponsors.

For more formation about board certification, visit www.acopne.org.



Wednesday, September 21

6:00 – 11:00 a.m. Registration, Coral Lounge						
6:30 a.m. – 1:00 p.m. Exhibit Hall Networking Break, Coral Ballroom 1-3 & Lounge						
6:30 – 8:00 a.m. Technical Sessions						
Track A South Pacific 1	Track B South Pacific 2	Track C South Pacific 3	Track D South Pacific 4	Track E Sea Pearl 1/2	Track F Sea Pearl 3/4	Track G Nautilus
8A Environmental	8B Port Engineering	8C Port Engineering	8D Port Planning & Operations	What Does It Take to Deliver a Mega Program? Examining Change and success:terminal 5 Rehabilitation	PORTS 101 – Material Solutions	8G Ports Infrastructure Development and Funding: Defining Needs and Exploring Opportunities
<p>Moderator: Ian Sequeira, P.E., M.ASCE</p> <p>Terminal Wide Industrial Stormwater Treatment on a 200-acre Container Terminal, Ellis Beckwith, P.E.; Emily Jones, P.E.</p> <p>Urban Waterfront Redevelopment Incorporating Sea-level Rise Considerations, Edmonds, Washington, Blaine McRae CET, CDT; Paul Crocker, P.E., S.E.; Shannon Kinsella, P.E., PMP, LEED AP</p> <p>Washington State Ferries Sea Level Rise Study, Abigail Gertz, P.E., M.ASCE; Aaron Porter, P.E., M.ASCE</p> <p>Whatcom Waterway Multiphase Remediation Project: Phase 2 Pre-design and Design Planning, Matt Woltman, P.E., P.E.ing</p>	<p>Moderator: Ryan McCoy, P.E.</p> <p>Designing Conveyors for Large Seismic Induced Displacements at a Port Facility, Daniel Chadwick P.Eng.; Ann-Marie Giesbrecht P.Eng.; Hamidreza Bakhtash Ph.D., P.Eng.; Steve Yee P.Eng., M.A.Sc.; Greg Andrew P.Eng.</p> <p>Over a Decade of Intensive Dredged Material Management – A Case Study of Maximizing Storage Capacity of a Confined Disposal Facility, Ramil Mijares Ph.D., P.E., M.ASCE; Kwasi Badu-Tweneboah Ph.D., P.E., D.GE, F.ASCE; Jeffrey Green, P.E.; Kenneth Cargill, P.E.</p> <p>Maritime Enhancements to the Bahamas’ Largest Seaport for Cruise Vessels, David Street, P.E., M.ASCE; Manfred Zinserling, P.E., S.E., M.ASCE; David Corbelli; Cagni Eturk</p> <p>Port Facility Needs for Construction of Fixed and Floating Concrete Substructures for Offshore Wind, Markus Wemli, P.E., Ph.D.; Jason Cotrell, MS, MBA; Phil Barutha Ph.D.</p>	<p>Moderator: Bradley Syler, P.E., S.E., M.ASCE</p> <p>PIANC WG211 – Reliability Based Design of Marine Fenders – No More Abnormal Berthing Factor, Rune Iversen, P.E., M.ASCE; Alfred Roubos Dr. MSc.; Prasanthi Miritagalla BSc, MEng, CEng, MICE</p> <p>Bollard Load Testing an Industry Update, Charlie Roberts, P.E., D.PE, M.ASCE</p> <p>Evaluation and Repair of a Damaged Sheet Pile Barge Dock, Tommy Howard, P.E., M.ASCE; Greg Buccola, P.E., S.E.</p> <p>Quantifying and Understanding Structural Loading from Wave-driven Debris Fields, Dakota Mascarenas; Abbey Serrone; Pedro Arduino Ph.D.; Marc Eberhard, Ph.D.; Michael Motley, Ph.D., P.E.</p>	<p>Moderator: William Young, P.E., S.E., M.ASCE</p> <p>A Resilient Path for the Marine Transportation System: Hurricane Response & Recovery Recommendations, Katherine Chambers MS; Jessamin Straub MS; Emily Russ; Joshua Murphy</p> <p>Advanced Modeling Techniques Make the First and Last Miles at the Port of Long Beach, Mark Erickson, P.E.; Beth Kulick BS, MS; Rick Degman</p> <p>NAVFAC Contingency Engineering Lessons Learned from Ports and Piers in the Pacific AOR, Stephen Jones Ph.D.</p> <p>Green Ports – Sustainable Port Development, Patrick McCallum BE</p>	<p>Moderator: Emma Del Vento AICP</p> <p>Panelists:</p> <p>Steven Gray, P.E., P.Eng., Senior Manager/Supervisory Engineer, Moffatt & Nichol</p> <p>Joanna Hingle, P.E., S.E., M.ASCE, Assistant Director of Engineering - Design, Port of Seattle</p> <p>Thais Howard, P.E., Director of Engineering, Northwest Seaport Alliance</p> <p>Jonathan Ohta, P.E., Senior Construction Manager, Port of Seattle</p> <p>Anne Porter, P.E., MBA, LEED AP, CSBA, Envision, Director Waterfront Project Management, Port of Seattle</p> <p>Jon Sloan, LEED AP, Senior Manager Maritime Environmental and Sustainability, Port of Seattle</p>	<p>Moderator: Jon Benvenuto, P.E., PMP</p> <p>Corrosion Causes Doug Leng, A.M.ASCE</p> <p>Corrosion Mitigation / Repair Techniques Doug Leng, A.M.ASCE</p> <p>Steel Sheet Pile Specification and Group Maria Idrovo</p> <p>Section Improvements: Performance vs Material Specification Steve Williams, P.E.</p>	<p>Moderator: Omar A. Jaradat, Ph.D., P.E., D.PE, M.ASCE</p> <p>Panelists:</p> <p>Eric Letvin, FEMA Mitigation Director</p> <p>Robert Bouchard, Director, MARAD Office of Port Infrastructure Development</p> <p>Rod Iwashita, Port of San Francisco</p> <p>Daley Dunham, Port of San Francisco Grant Specialist</p> <p>Lisa Scola, S&A Inc., Port Grant Specialist</p> <p>Mohammed Ettouney, Ph.D., IWAI BCA Expert</p> <p>This panel discussion will provide attendees with a practical understanding and overview of federal and state infrastructure grants, the trends in funding, and the capital improvement needs of port authorities.</p>
8:00 – 8:30 a.m. Exhibit Hall Networking Break, Coral Ballroom 1-3 & Lounge						



8:30 – 10:00 a.m. Technical Sessions						
Track A South Pacific 1	Track B South Pacific 2	Track C South Pacific 3	Track D South Pacific 4	Track E Sea Pearl 1/2	Track F Sea Pearl 3/4	Track G Nautilus
<p>9A Navigation & Waterways</p> <p>Moderator: Shane Phillips, P.E., D.CE, D.PE, M.ASCE</p> <p>Analysis of the U.S. Port Network Using AIS Data: Metrics for the Caribbean, David Young, Ph.D., P.E.; Marin Kress Ph.D.; Katherine Chambers MS; Brandon Scully Ph.D., P.E.</p> <p>Charleston Harbor Post 45 Deepening: A Success Story Through Collaboration, Edward Stehmyer, P.E., M.ASCE; Jeremy Johnson, P.E., PMP</p> <p>Designing a Yacht and Super Yacht Marina for the Pacific Coast of Peru, Daniel Natchez CMP; Jack Cox, P.E., D.CE, D.NE, D.PE, M.ASCE</p> <p>Jacksonville Harbor Dredged Material Management Long Term Assessment, Jonathan Armbruster, P.E., MS</p>	<p>9B Port Engineering</p> <p>Moderator: Max Argo, PE, M.ASCE</p> <p>Berth 11 Bulkhead, Paul Harrington, P.E.; Nathan Libby; David Melo, P.E.; Victor Govoni</p> <p>Kinematic Demands on Pile-supported Wharves due to Liquefaction-induced Lateral Ground Deformations, Thomas Torkelson, P.E.; Milad Souri Ph.D.; Nason McCullough Ph.D., P.E., G.E., M.ASCE; Arash Khasravifar Ph.D., P.E.</p> <p>Settlement and Bearing Capacity Mitigation of Organic Marine Deposits for Offshore Wind Staging Port, Mangtao (Monty) Du, PE.; Parang Deljouei, Ph.D., P.E., P.Eng, D.PE, M.ASCE; Theodore von Rosenberg, PE., D.GE; John Henshaw M.A.L.D.</p> <p>Soil, Structure, and Motion Factors Impacting Kinematic and Inertial Loading of Pile Foundations, Milad Souri Ph.D.; Stephen Dickenson Ph.D., P.E., D.PE., M.ASCE; Arash Khasravifar Ph.D., P.E.; Scott Schlechter, P.E., G.E., M.ASCE; Nason McCullough Ph.D., P.E., G.E., M.ASCE</p>	<p>9C Port Engineering</p> <p>Moderator: Rod Iwashita, P.E., D.PE, F.ASCE</p> <p>Accelerated Corrosion of Piling in Puget Sound Due to Microbial Activity, Ryan Tinnea NACE CP Specialist (CP-4); Michael Wray, P.E., M.ASCE, LEED AP; Jeri Bernstein, P.E., S.E.</p> <p>Structural Conditions Assessment and Monitoring of a 56-year Old Partially Relieved Graving Drydock, Monayem Akhand, Ph.D., P.E.</p> <p>Waterfront Resiliency at USCG Station Port Aransas, William Young, P.E., S.E., M.ASCE</p>	<p>9D Port Planning & Operations</p> <p>Moderator: Shannon Kinsella, P.E., PMP, LEED AP, M.ASCE</p> <p>Evaluation of Accelerated Rail Corrosion at Bulk Terminal, Port of Long Beach Pier G Berths 212-214 Terminal, Todd Graham D.PE, M.ASCE; Julia Wu Stephan, P.E., ENV-SP; Scott Wyatt, P.E., S.E.; Richard Lewis, P.E.; Ramanjit Brar, P.E.</p> <p>Inspection and Maintenance of Ferry Terminals – Risk Reduction and Cost Efficiency, Robert Seitz P.Eng; Taylor Carr ASCE; Carol Turner P.Eng; Tony Bleasdale</p> <p>Loading Capacity Planning and Management for the Washington State Ferries Multimodal Terminal, Isaac Ansingh; John Mansfield A.M.ASCE</p> <p>Maritime Planning at Smaller Scales, Thomas Ward, P.E., S.E., D.PE, M.ASCE; Hardik Gajjar ENV SP</p>	<p>9E Local Session 1</p> <p>Moderator: Morgan Stephenson, EIT, A.M.ASCE</p> <p>Lahaina Ferry Pier at Lahaina Small Boat Harbor Chris H Ball, A.M.ASCE; Emily Luke, A.M.ASCE</p> <p>American Samoa Climate Change Vulnerability Assessment for Transportation Infrastructure Jessica Podoski, P.E., MS</p> <p>Iroquois Point Beach Nourishment and Long-Term Monitoring Scott P. Sullivan, MS</p>	<p>PORTS 101 – Waterfront Construction</p> <p>Moderator: Allison DiGregorio, M.ASCE</p> <p>Designing for Constructability, Matthew McCarty, P.E., S.E., M.ASCE</p> <p>Precast, Prestressed Concrete Waterfront Structures, James Parkins, P.E., M.ASCE</p> <p>Construction Documentation, Matthew Martinez, P.E., S.E., D.PE, M.ASCE</p> <p>Service Life Estimation and Determination, Zachary D. Jenkins, P.E., S.E.</p>	<p>9G Updates from PIANC WG211 - Design of Fender Systems</p> <p>Moderator: Rune Iversen, P.E., M.ASCE</p> <p>An Introduction to the New PIANC Guidelines for the Design of Fender Systems 2022 by WG211, Alfred Roubos, Dr. MSc.</p> <p>PIANC Standardized Design Vessels, Rune Iversen, P.E., M.ASCE</p> <p>Recommendations for Berthing Velocity in PIANC WG 211, Alfred Roubos, Dr. MSc.</p> <p>Recommendations for Fender Testing in PIANC WG 211, Harvinder Singh, RPEQ, CPENG, FIEAust</p>
10:00 – 10:30 a.m. Exhibit Hall Networking Break, Coral Ballroom 1-3 & Lounge						
10:30 a.m. – 12:00 p.m. Technical Sessions						
Track A South Pacific 1	Track B South Pacific 2	Track C South Pacific 3	Track D South Pacific 4	Track E Sea Pearl 1/2	Track F Sea Pearl 3/4	Track G Nautilus
<p>10A Project Delivery</p> <p>Moderator: Matthew Teeden, P.E., S.E., D.OE, D.PE, M.ASCE</p> <p>Cost Estimating and Cost Management for Marine Construction, Zachary Jenkins, P.E., S.E.; Michael Deiters, P.E., CCP</p> <p>Port of Long Beach Middle Harbor Terminal: A Collaborative Approach to Port Project Delivery, Monique Lebrun, P.E., M.ASCE; Ashebir Jacob, P.E., M.ASCE; Reza Alami, P.E., M.ASCE; Cesar Larios, P.E., CCM</p> <p>Recapitalization of a 40 Year Old Dry Dock: Project Insights, Risk Management, and Team Building, John McCoy, P.E., M.ASCE; Michael Brengel, P.E.; Amy Hoffer, P.E.; Daniel Cloutier, P.E.</p> <p>Strategic Waterfront Infrastructure Investment Plan for Joint Base Pearl Harbor-Hickam, Daniel O'Connor, P.E., M.ASCE; Daniel Stromberg, S.E., P.E., M.ASCE</p>	<p>10B Port Engineering</p> <p>Moderator: Jack Koban Ph.D., P.E., P.G., M.ASCE</p> <p>Proposed Revisions to Design and Detailing of Piles and Pile-to-Deck Connections in ASCE/COPRI 61-22, Carlos Ospina, Ph.D., P.E.; John Smith, Ph.D., P.E., S.E., M.ASCE; Edyson Rojas, P.E.</p> <p>Soil Liquefaction and Kinematic Loads Evaluation for Seismic Design of Pier in Slopes, King Chin, P.E., M.ASCE; Yanbei Zhang, Ph.D., P.E.</p> <p>Successful Implementation of Award-Winning FRP Monopiles for Jamestown-Scotland Ferry Terminals, Corey Sechler</p> <p>Upgrades and Extension of Service Life for Dry Dock 1 at Naval Base San Diego, Henrik Dahl, P.E.; James Connolly, P.E., DPE; Victor Tirado, P.E.; Alberto Sanchez, P.E.</p>	<p>10C Port Planning & Operations</p> <p>Moderator: Matthew Martinez, P.E., S.E., D.PE, M.ASCE</p> <p>Pier Design vs. Operations (A Navy Perspective), Anthony Farmer, P.E., M.ASCE</p> <p>Planning Waterfront Emergency Response Facilities with the Future in Mind, Craig Lewis, S.E.; Satish Chilka, P.E.; Magdalena Ryor, Ph.D., LEED AP, BD+C, CCM, PMP</p> <p>Small Ports in Transition - Port of Woodland, Washington, Scott Keillor AICP; Jennifer Wray-Keene; Brian Carrico AICP; Sam Roberts AICP</p> <p>Systematic Approach to Predicting Remaining Service Life of U.S. Navy Piers, James Connolly, P.E., DPE; Anne-Marie Langlois P.Eng., P.E.; Henrik Dahl, P.E.; Alberto Sanchez, P.E.; Monica Martinez-Maruri</p>	<p>10D Equipment and Systems</p> <p>Moderator: John Chapman</p> <p>Digital Twins for Safe and Efficient Port Infrastructure Management, Barritt Lovelace, P.E.; Bibhuti Aryal</p> <p>Maintaining the Historic Alaska Marine Highway System, Jordan Furlan, P.E.; Robert Davies, P.E.; Bradley Syler, P.E., S.E., M.ASCE</p> <p>Port of Long Beach: Transforming Terminal Infrastructure and the Push to Zero Emissions, Fred Patricia; Not Applicable; Morgan Caswell MPH</p> <p>The Gò Công International Port and Landside Development, Reece Shaw, P.E.; Khang Dang BS</p>	<p>10E Local Session 2</p> <p>Moderator: Morgan Stephenson, EIT, A.M.ASCE</p> <p>Ocean Hazards on Coastal Infrastructure in Hawaii Oceana, Francis, Ph.D., P.E., M.ASCE</p> <p>Pearl Harbor SIOP, Sean Hanser, Ph.D.</p>	<p>PORTS 101 – Port Management and Operations</p> <p>Moderator: Norisa Abelas, P.E., M.ASCE</p> <p>Owners and Engineers Common Ground, Todd Mitchell, CP, M.ASCE</p> <p>Public Port Perspective Rod K. Iwashita, P.E., D.PE, F.ASCE</p> <p>Container Terminal Operations, Thomas A. Ward, P.E., S.E., D.PE, M.ASCE</p> <p>Port Economics, Alfred Roubos, Dr. MSc.</p>	<p>Sustainability & Resilience Discussion – Mitigation</p> <p>Moderator: Leo Barco, P.E., D.PE, F.ASCE; Joel Farrier, P.E., MBA, M.ASCE</p>



JOIN OUR TEAM!

Stantec's ports and marine terminals professionals design and support innovative, unique projects worldwide.

Visit booth #203 to discover where a career at Stantec can take you.

PORTS '22
PREMIER
SPONSOR

[Learn more](#)



Exhibit Hall Floor Plan

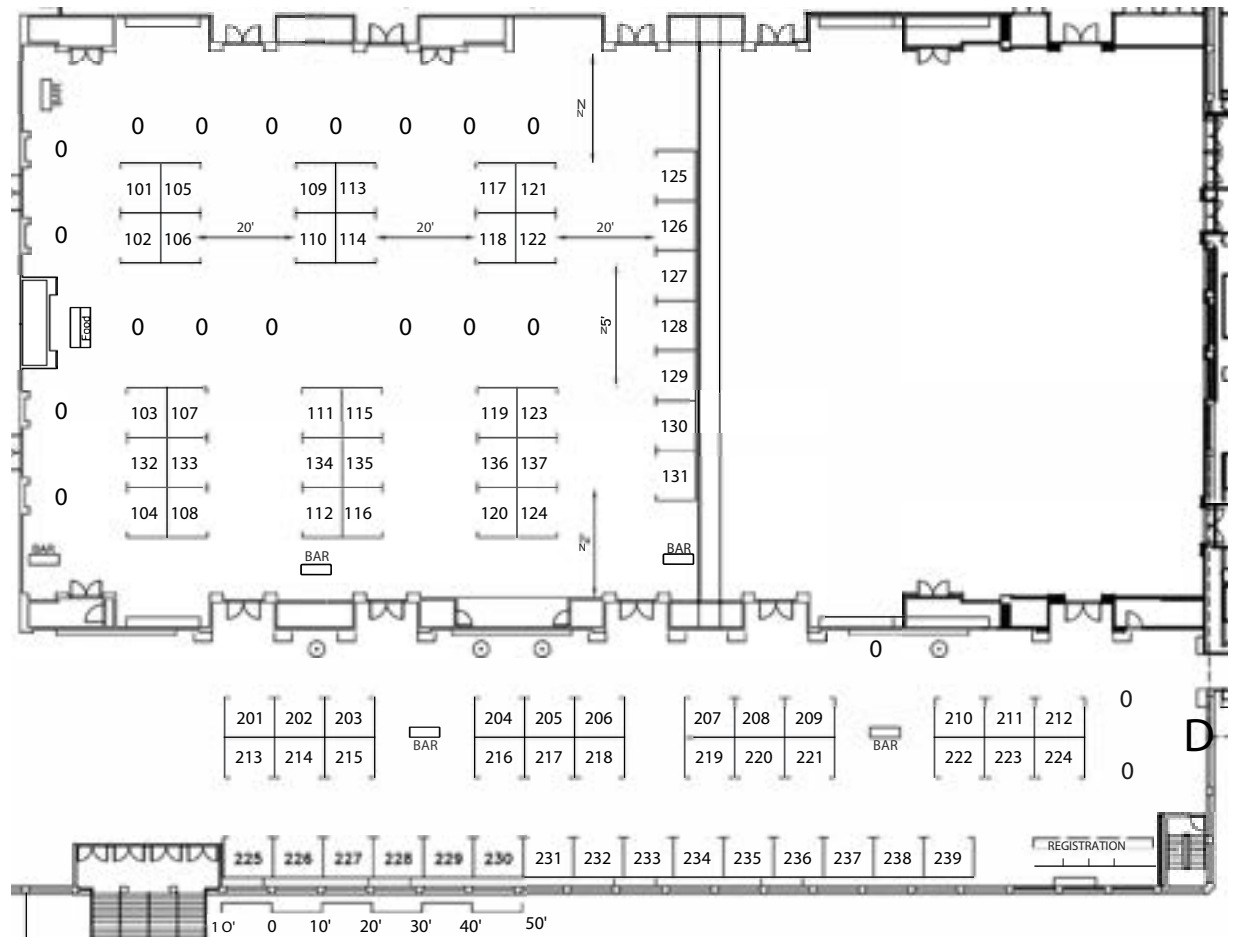

120
ACO, INC
www.acousa.com

ACO provides systems for professional surface water drainage, efficient cleaning, and the controlled discharge or reuse of water.

237
Advisian - Worley
www.advisian.com

Advisian is a leading provider of professional services to the resources and energy sectors and complex process industries.

228
AECOM
www.aecom.com

With over 90,000 employees — including architects, engineers, designers, planners, scientists and management and construction services professionals — serving clients in more than 150 countries around the world, AECOM is the premier, fully integrated infrastructure and support services firm worldwide.

202
American Marine Corp
American Marine Corp

American Marine Corporation offers Marine Construction, Commercial Diving, Transportation, Crew Boat Services, Marine Vessel Inspection & Repair, Vessel Support, Vessel Salvage, Towing Services, Emergency Repair, Logistics, Waterfront Services, and Environmental Remediation.

127
Anchor QEA, LLC
www.anchorqea.com

Anchor QEA is a nationally recognized environmental science and engineering consulting firm that specializes in waterfront redevelopment, contaminated sediment remediation, and water resource management.

230
Aquaveo
www.aquaveo.com

Our software solutions provide engineers tools for modeling groundwater and surface-water in the areas of hydrology and hydraulics to help complete demanding water resources projects.

116
ASCE Future World Vision
www.futureworldvision.org

Reimagine the world and shape the future. Innovation does not happen in a vacuum. The Future World Vision initiative grounds critical conversation in a shared vision from which civil engineers will be able to visualize, design, and create the future of infrastructure. Join us in taking this first step towards the future of infrastructure with a gift in support of this bold and comprehensive project.

112
Atlantic Track - Crane Runway Division
www.atlantictrack.com

Atlantic Track is recognized as a highly reliable source for quality and cost effective engineered crane runway system solutions by Port Operators and their Consultants

121
Bellingham Marine Industries
www.bellingham-marine.com

Bellingham Marine (BMI) is the world leader in the design, manufacture, and construction of marinas and related products and services.

Exhibit Hall Hours

Sunday, September 18

12:30 – 6:30 p.m.	Exhibitor Move-in
6:30 – 8:00 p.m.	Exhibits Open
6:30 – 8:00 p.m.	Ice Breaker Welcome Reception

Monday, September 19

6:30 a.m. – 5:00 p.m.	Exhibits Open
10:00 – 10:30 a.m.	Exhibit Hall Networking Break
12:00 – 1:00 p.m.	Exhibit Hall Lunch

Tuesday, September 20

6:30 a.m. – 5:00 p.m.	Exhibits Open
8:00 – 8:30 a.m.	Exhibit Hall Networking Break
10:00 – 10:30 a.m.	Exhibit Hall Networking Break
12:00 – 1:00 p.m.	Exhibit Hall Lunch

Wednesday, September 21

6:30 a.m. – 1:00 p.m.	Exhibits Open
8:00 – 8:30 a.m.	Exhibit Hall Networking Break
10:00 – 10:30 a.m.	Exhibit Hall Networking Break
1:00 – 5:00 p.m.	Exhibitor Move-out

118

Birdzoff

www.birdzoff.com

Birdzoff recognizes that birds of prey and other pest birds are not only a nuisance but also a hazard for your industrial facilities. Our bird control products work effectively- saving you time and money and improving worker safety. That's why for 30 years industry leaders have trusted us to create state-of-the-art solutions for the toughest of industrial bird control problems.

227

BollardScan

bollardscan.com

The BollardScan™ is a unique way to establish the integrity of the bollard and its foundation. And whether it still meets the design requirements of the structure. The methodology that was developed in-house is based on the transmission of vibration and sound through the structure allowing us to pinpoint any errors.

213

Burns & McDonnell Engineering Company, Inc.

www.burnsmcd.com

We design and build the tangible and intangible, everything you see (and don't see) that helps our cities thrive. We've worked relentlessly to make our clients and our communities successful since 1898, because we know safe, essential infrastructure is the foundation of a flourishing society.

221

Carmel Corrosion Systems, Inc.

www.carmel-corrosion.com

CCS produces protection pile wraps, customer designed against corrosive marine environments. Easy installation on piles, risers, dolphins, used inland, off-shore and deep sea.

238

Commercial Metals Company - ChromX

cmc.com

ChromX is a high strength, corrosion resistant rebar produced by Commercial Metals Company as part of the specialty products division. ChromX provides superior corrosion resistance of more than 100 years of service left before the first repair in our CS product while simultaneously providing 100 - 120 KSI strength.

136

COPRI

asce.org/copri

Created in 2000, the Coasts, Oceans, Ports, and Rivers Institute (COPRI) is a semi-autonomous institute of the American Society of Civil Engineers (ASCE), the country's oldest national engineering society. COPRI's services are designed to complement ASCE's traditional civil engineering base and to attract non-engineering allied professionals who seek to enhance their professional and technical development.

210

COWI

www.cowi.com

Port and harbor engineering services, including underwater investigation, structural and geotechnical design, berthing analysis, dredging design, permitting, construction support, resident engineering, and coastal engineering services.

122

Creative Composites Group

www.creativecompositesgroup.com

The Creative Composites Group delivers innovative, engineered solutions so that our customers take advantage of the benefits of Fiber Reinforced Polymer (FRP) composites. This means our customers have products that are lightweight, high strength, corrosion-resistant, and long-lasting! The Creative Composites Group combines the expertise of many companies to offer the best in composite design and advanced manufacturing processes.

209

Denso North America

www.densona.com

Denso is a leader in marine corrosion protection. Our SeaShield Marine System provides full line of steel, concrete and timber pile protection and rehabilitation.

124

EJ USA, INC.

www.ejco.com

Infrastructure access solutions for seaport applications - from EJ - leaders in design, manufacture and distribution for water, sewer, drainage, telecommunications and utility networks worldwide.

137

Epoxy Interest Group of CRSI

www.epoxyinterestgroup.org

The Epoxy Interest Group (EIG) of CRSI (Concrete Reinforcing Steel Institute), is a not-for-profit trade association providing an authoritative resource for information related to use of epoxy-coated steel (epoxy rebar) in reinforced concrete. Epoxy-coated reinforcing steel is also known as ECR, epoxy-coated rebar, fusion bonded epoxy coated rebar or FBECR.

110

ForSHORE

www.forshore-ports.com

ForSHORE operates as a General Contractor to deliver all four stages in the development of port infrastructure projects: financing, design, build, and maintenance. ForSHORE provides the best risk management related to the ground-infrastructure interaction to build resilient, lasting ports. ForSHORE offers a full range of port infrastructure capabilities: Jetties, quays, dry docks, locks, breakwaters, dolphins, foundations for platforms, storage tanks and buildings, sea outfall/intake. ForSHORE capitalises on Soletanche Bachy's global reach and local presence and on the Group's geotechnical expertise and solutions.

125

FYFE

www.cs-nri.com/brands/fyfe-frp

Fyfe FRP - Advanced Composites for Structural Strengthening Over time, the stresses of daily wear take their toll on pipelines, bridges, tanks, buildings, and other structures. Fyfe® develops and designs materials that strengthen, repair, and restore these deteriorating structures—sometimes to better-than-new condition.

104

Gantrex Inc.

www.gantrex.com

Gantrex is the leading provider of runway components for STS and Overhead Cranes. Our solutions include crane rail, pad, clips and concrete-supported rail products.

211

GEI Consultants, Inc.

www.geiconsultants.com

Driven by a culture of collaboration and entrepreneurial spirit, GEI engineers and scientists partner with clients to improve communities, infrastructure, and the environment. We leverage the best talent in the industry to move you forward.

232

Haley & Aldrich

www.haleyaldrich.com

Haley & Aldrich, Inc. is committed to delivering the value our clients need from their capital, operations, and environmental projects. Our one-team approach allows us to draw from our 800 engineers, scientists, and constructors in 33 offices for creative collaboration and expert perspectives. Since our founding in 1957, we have one goal in all we do: deliver long-term value efficiently, no matter how straightforward or complex the challenge. In 2020, Haley & Aldrich acquired Hart Crowser, an engineering and environmental consultancy with extensive expertise in the Pacific Northwest and recognized for its cutting-edge performance-based seismic design methods. Visit www.haleyaldrich.com.

235

Headed Reinforcement Corp. (HRC)

www.hrc-usa.com

High Performance Reinforcement Products for Structural Integrity and Constructability

225

HUESKER + Proserve Ltd.

www.huesker.us

HUESKER is the world's leading manufacturer of geosynthetics, agricultural, and industrial textiles. Providing solutions for Earthworks and Foundations, Roads and Pavements, Environmental Engineering, Hydraulic Engineering, Industry and Agriculture.

113

Igus

www.igus.com

Over 30 million parts and 4 million feet of cable stocked in the USA - shipped as early as today. Long-lasting, self-lubricating plastics.

129

IRM Offshore and Marine Engineers Pvt Ltd

www.irmome.com

IRM Offshore and Marine Engineers Private Limited is a global leader, offering more than 2,000 speciality rubber engineering products and various services for the shipbuilding industry, maritime infrastructure, offshore oil drilling platforms, Offshore wind energy & naval establishments.

208

Kongsberg Maritime

www.kongsberg.com/maritime

Kongsberg Maritime is a world leader in marine technology. With an extensive portfolio of innovative and integrated products and solutions, Kongsberg Maritime delivers efficiency, reliability, flexibility, and environmental sustainability to enhance the business of its customers. Our approach to product design maximize performance by providing THE FULL PICTURE.

207

Manson Construction

www.mansonconstruction.com

Manson Construction Co. is a leading heavy civil marine contractor with a fleet of heavy marine equipment that includes 60 specialized vessels and over 50 barges. Our services include dredging, waterfront construction, bridge building, heavy lifts, and off

204

Marine Solutions, Inc.

www.msimarinesolutions.com

Marine Solutions is a small, woman-owned, DBE specialized construction and engineering firm focused on building and maintaining waterfront, hydraulic, navigation, and bridge structures.

132

Marubeni America Corporation

www.marubeniamerica.com

Marubeni America Corporation, which we also refer to as "MAC", is a general trading company, engaged as an intermediary, importer/exporter, facilitator or broker in various types of trade between and among business enterprises and countries.

224

McCarthy Builders

www.mccarthy.com

Established in 1864, McCarthy Building Companies, Inc. has a long history of building facilities that drive greater value. From exceptional levels of quality and safety — to ease of maintenance over time, we are firmly committed to helping our clients and partners achieve the short- and long-term strategic goals of every project we do.

231

McLaren Engineering Group

www.mgmclaren.com

McLaren Engineering Group's marine department provides underwater inspection, design, permitting, and construction services in support of structural, geotechnical, rehabilitation, dredging, and coastal engineering projects worldwide.

109

Menard USA

www.menardusa.com

Menard USA is one of the leading specialized ground improvement contractors in the U.S., with over 30 years of experience. We are the U.S. affiliate of Menard, a global leader among ground improvement contractors with offices in over 30 countries. Menard USA was formed as a merger between DGI (Drainage & Ground Improvement, Inc.), a leading Vertical Wick Drain installer in the US, and Menard.

103

Michels Corporation

www.michel.us

A diversified global leader in energy and infrastructure construction, Michels offers proven combination of services and a distinctive culture unique to the industry. As a family-owned and operated business, we support our customers' infrastructure needs with decades of experience; the ability to make swift, strategic decisions, and an uncompromising commitment to our safety-first mindset.

214

Mid-America Engine

www.midamericaengine.com

We are an industry leader for new, used and surplus power generation equipment. Our inventory is extensive – from 13kW to 1.5MW. It includes high quality diesel generator sets, power modules and gas turbines. We are truly able to respond, and quickly deliver, all of your power generation needs.

217

Mitsubishi Chemical Group

www.mitsubishichem-hd.co.jp/english

With 80 years of experience and 30 branch offices, we are the global leader for researching, developing, and manufacturing high-performance, engineered polymer materials.

201

Moffatt & Nichol

www.moffattnichol.com

Moffatt & Nichol is a leading U.S.-based global infrastructure advisor specializing in the planning and design of facilities that shape our coastlines, harbors and rivers as well as an innovator in the transportation complexities associated with the movement.

220

Mott McDonald

www.mottmac.com

Mott MacDonald is a vibrant infrastructure development and engineering company with 180 offices worldwide and over 60 offices in the United States and Canada.

223

NorthSouth GIS (NSGIS)

www.nsgis.com

NorthSouth GIS LLC (NSGIS) is one of the most respected geospatial systems implementation and integration consulting firms in the United States. We are passionate about: Ports globally; Water and Wastewater Utilities nationally; Local Government in Southern California.

205

Nucor Skyline

www.nucorskyline.com

The Vulcraft/Verco Group, a part of Nucor Corporation, is the nation's largest manufacturer of steel joists, joist girders and steel deck.

234

Pacific Pile & Marine

www.pacificpile.com

Pacific Pile & Marine (PPM) is a heavy civil and marine contractor specializing in complex construction, especially in remote locations. Our team has experience in alternate delivery and is sufficiently resourced to deliver a wide range of construction services.

134

PIANC

www.pianc.org

PIANC is the World Association for Waterborne Transport Infrastructure. It is an international association composed of governments, private sector companies, academics, and individual professionals that works to advance the sustainable development of maritime and inland navigation.

236

PipeMedic by QuakeWrap

www.pilemedic.com

PipeMedic® by QuakeWrap is the industry leader in the development of innovative, sustainable FRP pipes and pipe repair systems for new construction and repair of existing pipelines.

215

Precast/Prestressed Concrete Institute (PCI)

www.pci.org

The Precast/Prestressed Concrete Institute (PCI) is the technical institute and trade association for the precast concrete structures industry.

108

Ritek

www.riteks.com/protective-coatings

RITEKS provides the highest performing, US Navy approved, Splash Zone and Protective Coatings for the harshest environments: Ports, Marine Assets and Waterfront Structures.

216

Roller Compacted Concrete Pavement Council

www.agpeltz.com

The Roller Compacted Concrete (RCC) Council is an organization committed to the promotion and research of RCC Pavements. RCC has been used at several port facilities for container stacking and heavy industrial storage. This includes Bayport (Houston,

218

Roxtec

www.roxtec.com

We provide complete sealing solutions for a wide range of applications in many industries. Roxtec safety seals are found on land, at sea and underground. Our co-operation with customers creates excellent conditions for continuous development. The teamwork enables us to tailor new solutions – and stimulates us to keep on exploring new markets.

131

S.T. Hudson Engineers, Inc.

www.sthe.com

Our experienced team comprised of engineers, environmental specialists, hydrographers, commercial hard hat divers, estimators, construction managers, and inspectors are readily available to assist our clients on all aspects of a project from the docks to the tanks and everything in between.

333

SEA Engineering

www.seaengineering.com

Sea Engineering, Inc. was founded in 1973 by University of Hawaii graduate students to provide marine-related engineering, construction and diving services. Today, our company has three office locations in Hawaii and California and over 90 employees. Our core services include coastal engineering, geophysical surveys, oceanographic and environmental studies, as well as marine waterfront construction and industrial diving.

114

ShibataFenderTeam Inc

www.shibata-fender.team

One of the leading fender manufacturers, 50+ years of group experience, extensive global network, focused on in-house manufacturing, offering the full range of fender products.

102

Simpson Gumpertz & Heger (SGH)

www.sgh.com

SGH is a national engineering firm with more than 25 years' experience in condition assessment, structural evaluation, failure risk analysis, failure investigation, and repair of pipelines.

219

Site Scout 360

www.synergy360.co

Synergy 360 specializes in rapidly collecting accurate on-site measurement data to produce 360 video walkthroughs, floor plans, and models for indoor and outdoor space management projects. From simple to complex sites, we capture the data and information you need to complete your projects faster, more efficiently, and at lower cost, increasing your project bottom line.

203

Stantec
Stantec

We're designers, engineers, scientists, and project managers, innovating together at the intersection of community, creativity, and client relationships. Balancing these priorities results in projects that advance the quality of life in communities across the globe.

123

Straatman BV

www.mfstraatman.com

With over 50 years of experience in the design and manufacture of mooring equipment, Straatman is your go-to partner in order to guarantee safe and efficient mooring operations at LNG, oil, and container terminals. We are an established supplier of Quick Release Mooring Hooks, Berthing Aid Systems and sophisticated ATEX / IECEx certified solar systems for the maritime market.

115

Structural Group

www.structuraltechnologies.com

Structural Technologies, a Structural Group company, develops and integrates specialized products with engineering services to improve, protect and enhance water and wastewater pipelines. Its unique product systems provide structural strengthening for the restoration or renewal of concrete, metallic, and polymer-based large diameter pipelines. Its repair options include state-of-the-art materials, which provide engineered value through short construction windows with little to no disruption to traffic patterns or operations.

106

Synhetex

www.synhetex.com

Synhetex is the leading manufacturer and principal supplier of HYDROTEX® highly engineered fabric formed concrete erosion control and scour protection systems.

119

Tangent Materials

tangentmaterials.com

Strength. Durability. Aesthetics. For those who need a combination of strength, durability and aesthetics outdoors, Tangent delivers unrivaled performance in alternative materials that are made to live on.

105

Taylor Engineering, Inc

www.taylorengineering.com

Taylor Engineering, a Federal Small Business, specializes in water-related engineering, planning, and environmental challenges with particular emphasis on coastal regions.

212

Tensar

www.tensarcorp.com

At Tensar, we love solving earthwork problems with innovative, resilient solutions and sharing that passion with others. We're here to support you with proven technology, proven project successes, and greater total value that delivers proven savings.

126

Tokyo Rope Company

www.tokyoropeco.jp

Manufacturing and sales of wire rope, steel cord, Carbon Fiber Composite Cable (CFCC): design and construction of road safety devices such as rock fall prevention net, environment protection products such as sound insulation walls, and bridges and cable-suspended bridges: manufacturing and sales of various industrial machinery and metal fiber

107

Tough Leaf

www.toughleaf.com

To facilitate a diverse and thriving environment where contractors can seamlessly meet and exceed their D/M/WBE goals on projects.

229

Taylor Bros.

www.traylor.com

Our Mission is to excel at constructing complex infrastructure safer, better, and faster by engaging the entrepreneurial and innovative spirit of our team members and providing limitless opportunity for personal and professional growth in a close knit and collaborative organization.

128

Trelleborg Marine & Infrastructure

www.trelleborg.com/en/marine-and-infrastructure

With a smarter approach to port and terminal efficiency, Trelleborg Marine Systems offers a broad range of solutions spanning marine fenders, oil and gas transfer, ship performance, docking and mooring and piloting and navigational aids.

111

Trimble

www.tekla.com/us

Tekla software by Trimble enables engineers to design and analyze buildings, produce professional construction documentation and calculations as well as provide full detailing services.

130

Vector Corrosion Technologies

www.vector-corrosion.com

Vector Corrosion Technologies has innovative solutions for concrete corrosion repair and protection in reinforced concrete structures including: embedded galvanic anodes, galvanic jackets, activated arc-spray zinc metallizing, corrosion detection and evaluation, repair and mitigation services for post-tension corrosion.

101

Whitney Bailey Cox & Magnani (WBCM)

wbcm.com

Founded in 1977, WBCM's Marine Engineering Division specializes in the planning, inspection, rehabilitation, repair, renovation, and design of marine structures and landside support facilities.

239

Williams Form Engineering

www.williamsform.com

Williams Form Engineering Corporation has been offering Ground Anchors, Concrete Anchors, Post Tensioning Systems, and Concrete Forming Hardware to the construction industry for over 95 years.

206

WSP

www.wsp.com

Since the development of the original Panama Canal, WSP—including former BergerABAM and Louis Berger—has worked with port authorities and terminal operators worldwide to plan, design and manage the construction of maritime infrastructure including cargo, passenger, recreation and military facilities. Our maritime specialists are committed to using the latest technology to deliver Future Ready™ solutions.

Hotel Floor Plan

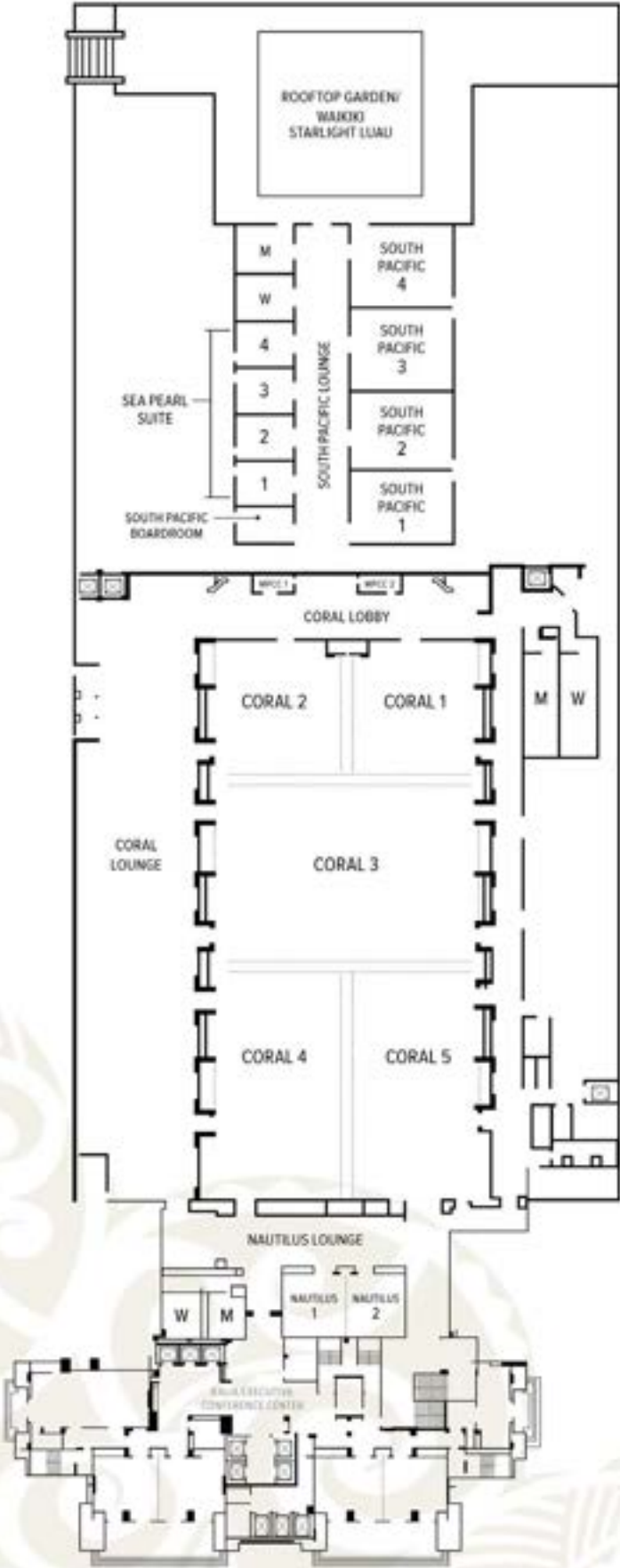

General Information

Assumption of Risk

All ASCE/COPRI events and activities are purely voluntary activities, and attendees are fully responsible for their own conduct and well-being, including, and without limitation, determining their level of fitness to take part in any such event or activity. In participating in any event or activity, attendees shall be deemed to understand and accept all risk of possible physical injury that might occur as a result of such participation. Children under the age of 18 are not allowed in the exhibit hall.

Attire

The dress code for the conference is Hawaiian "Aloha" Casual.

Meeting room temperatures will vary, so be sure to dress with your personal comfort in mind.

Badge Policy and Ribbons

Your name badge is your admission to the educational sessions. Please wear your badge at all times while in the hotel. ASCE/COPRI recommends you remove your badge when leaving the hotel. Tickets are required for meal events. Where tickets are required, please be sure to bring your tickets with you to each event as you will not be admitted without a ticket. Ribbons will be available at the Registration Desk.

Diversity and Inclusion

The ASCE/COPRI policy of Diversity and Inclusion fosters a culture that encourages the free expression and exchange of engineering ideas by all members, regardless of gender, race, ethnic origin, religion, age, marital status, sexual orientation, disabilities, or any other reason not related to scientific or technical merit.

Medical Emergencies

The Hilton Hawaiian Village and ASCE/COPRI hopes that your visit to PORTS® '22 will be free from illness or injury, but in case you or a family member needs medical attention during your time at the event, contact the front desk or consider visiting the nearby urgent care facility.

Queen's Island Urgent Care - Kapahulu

449 Kapahulu Ave., Suite 104,
Honolulu, HI 96815
(808) 735-0007

Meeting Room Overcrowding

ASCE/COPRI will make every effort to schedule popular events in rooms large enough to accommodate anticipated attendance. Since many events are extremely popular, it is wise to select alternative events as you plan your conference schedule. ASCE and the Hilton Hawaiian Village are REQUIRED to follow local fire regulations and may ask participants in rooms filled to capacity to choose another event.

Professional Development Hours (PDHs)

You may earn PDHs, which are nationally recognized units of record, by attending pre-conference workshops and conference concurrent sessions. Please note there are differences from state to state in continuing education requirements for professional engineering licensure. Each state licensing board has the final authority to approve course, credits, PDHs, and other methods of earning credits in that state. ASCE strongly recommends that individuals regularly check with their state licensing boards for specific continuing education requirements in their jurisdictions that affect professional engineering licensure and the ability to renew licensure.

Program and Session Cancellation

ASCE/COPRI reserves the right to cancel programs and/or sessions. In the unlikely event of a cancellation, all registrants will be notified. Programs and sessions are subject to change, and ASCE reserves the right to substitute a program, session, and/or speaker of equal caliber to fulfill the educational requirements.

Photographs and Video

Photographs and Video of the event may be taken by ASCE, its agents, contractors, or representatives, and such photographs and video may be used for any purpose at ASCE discretion.

Registration Hours

**Registration Hours*

**Closed for lunch 11:30 a.m. – 12:30 p.m. Sunday, and 12:00 – 1:00 p.m. Monday and Tuesday*

<i>Sunday, 9/18</i>	<i>6:00 a.m. – 7:00 p.m.</i>
<i>Monday, 9/19</i>	<i>6:00 a.m. – 5:00 p.m.</i>
<i>Tuesday, 9/20</i>	<i>6:00 a.m. – 5:00 p.m.</i>
<i>Wednesday, 9/21</i>	<i>6:00 – 11:00 a.m.</i>

The registration desk is located in the Coral Lounge.



Visit us at booth
#136 to learn how
you can get involved.
asce.org/copri





PORTS® '22

Honolulu, Hawaii | September 18-21, 2022



Thank You to Our Sponsors!

Contributions from the following sponsors will enable the PORTS® '22 Conference to continue its commitment to excellence in programming and networking events for attendees.

Premium



Platinum



Gold



Silver



Bronze



Corporate Sponsors



Cooperating Organizations

